

Shared Ownership at **ABODE** Cambridge



The Abode Development

Built by Countryside and offered for Shared Ownership sale through bpha, we have a selection of three bedroom houses available to purchase on the award winning Abode development in Cambridge.

Location

Abode occupies a prime position within Great Kneighton with excellent community, transport, education and work facilities all within easy reach. Situated approximately 3 miles from Cambridge city centre and adjacent to a new 120-acre Country Park, these new homes really couldn't be better placed.

The Cambridgeshire Guided Busway (CGB) is set to have an access point at Great Kneighton, just minutes from Abode. The CGB provides the fastest and most reliable bus service in Cambridge, reaching the city centre and train station in approximately 20 minutes, stopping at Addenbrooke's Hospital and the Science Park.

Great Kneighton is just a few minutes from the M11 motorway for London, Stansted airport and the nearby towns of Newmarket, Huntingdon and Norwich.

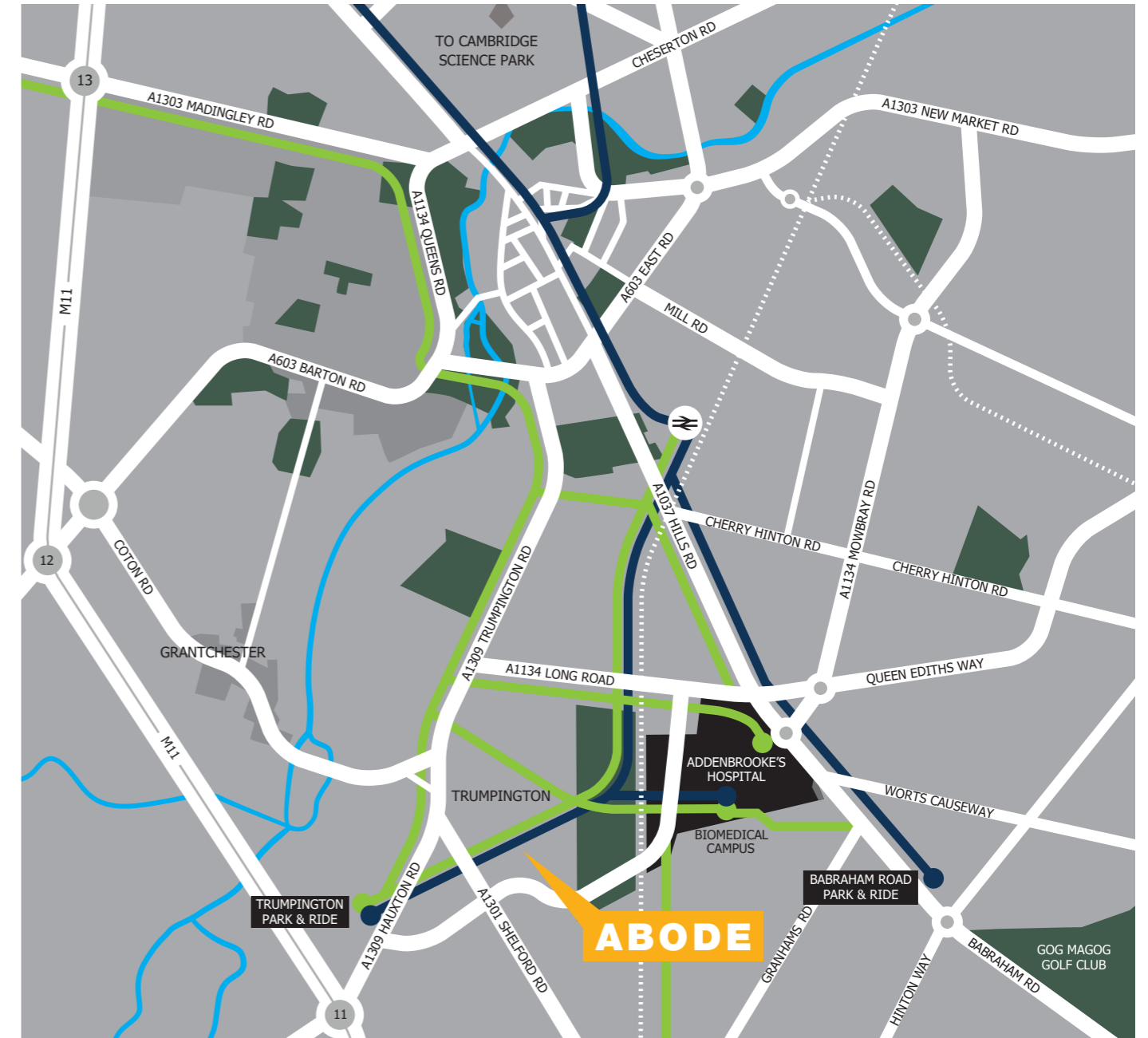



Specification

Kitchen Specification

- Symphony 'Woodbury Ivory' kitchen cupboards
- Symphony 'Oak block' laminate worktop with upstand
- Integrated oven, hob & cooker hood
- Fridge-freezer and washing machine provided
- Dark grey ceramic floor tiles

General Specification

- Carpet to lounge, hallway, stairs/landing & bedrooms
- High specification bathroom finish
- Off road parking for two cars
- Gas radiator heating
- NHBC warranty

**bpha reserves the right to change the specification and design at any time.*

Floor Plans

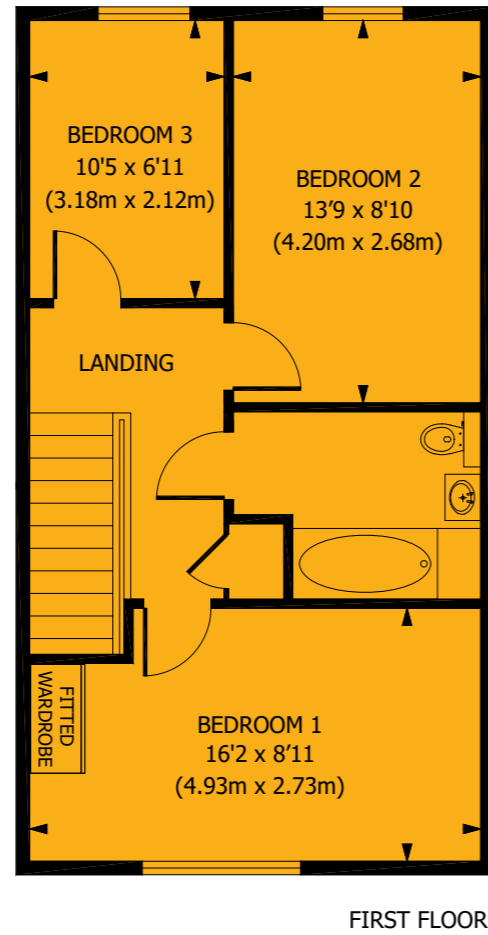
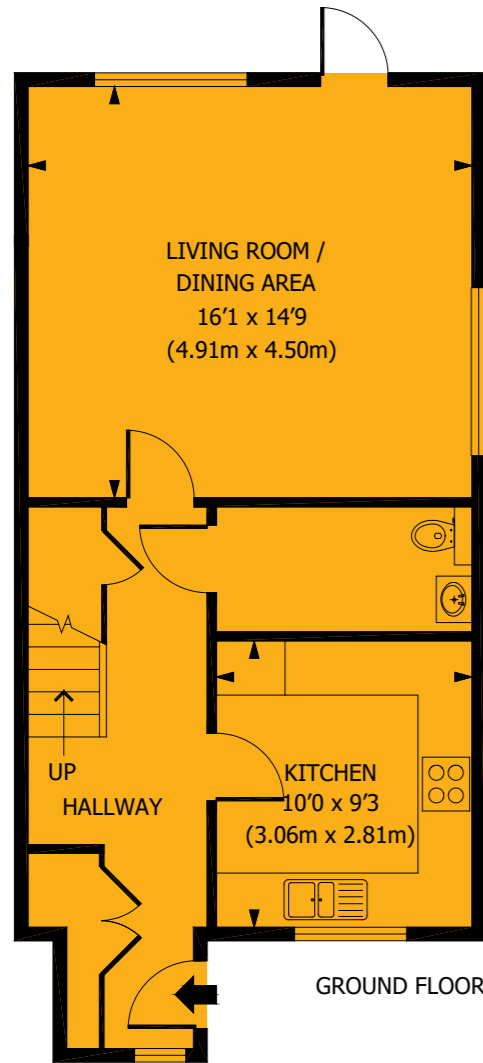

3 Bedroom House
Plots: 116*, 117, 118*, 119*

* Plot layouts and dimensions may differ

Site Plan





How does the scheme work

If outright purchase is not an option for you, Shared Ownership offers an alternative to renting. You can buy an initial share in a new home that you can afford, helping you into home ownership in manageable stages.

bpha will offer an initial share of between 25%-75% of the property. You pay a subsidised rent on the remaining share that bpha still own. The combined monthly cost of mortgage and rent can often be less than if you were purchasing the property outright.

In the future you can simply sell your share for its value at the time or alternatively you can purchase further shares in your home, this is called Staircasing.

Example

Property Value	£422,000*
25% Share	£105,500*
Monthly Rent	£725.31*

* Subject to change - guide only.

**Properties are subject to a monthly service charge.





bpha is a non-profit making housing association that manages more than 18,000 homes.

bpha Limited is a Registered Society under the Co-Operative and Community Societies Act 2014 (26751R) and is also registered with the Homes and Communities Agency (LH 3887).

Registered Office:
Bedford Heights
Manton Lane
Bedford
MK41 7BJ

Telephone: 0330 0535 131

Email: info@bphaoptions.org.uk

Web: bphaoptions.org.uk

