

## New Product Riser Blocks

Update #2374

Attention: Dayton Parts' Distributors and Business Partners.

Dayton Parts would like to make you aware of new product availability: Riser Blocks

Inventory is available now for ordering.

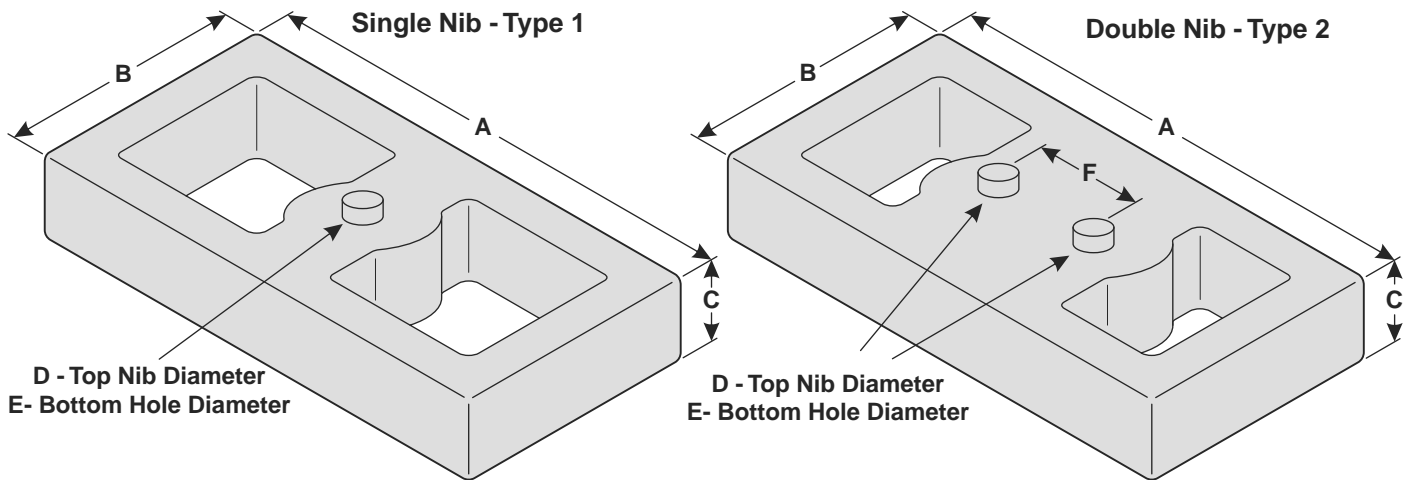

Type	Part No.	A	B	C	D	E	F	Use With
1	<b>SPA-1</b>	6"	2 1/2"	1"	.55"	.58"	—	3/8" Center Bolt
1	<b>SPA-2</b>	6"	3"	1"	.61"	.64"	—	7/16" Center Bolt
1	<b>SPA-3</b>	7"	3"	1"	.73"	.77"	—	1/2" Center Bolt
1	<b>SPA-4</b>	7"	3 1/2"	1"	.73"	.77"	—	1/2" Center Bolt
1	<b>SPA-5</b>	7"	4"	1"	.61"	.64"	—	7/16" Center Bolt
1	<b>SPA-6</b>	7"	4"	1"	.73"	.77"	—	1/2" Center Bolt
1	<b>SPA-9</b>	6"	2 1/2"	1"	.73"	.77"	—	1/2" Center Bolt
2	<b>SPA-7</b>	6"	3"	1"	.77"	.77"	1.56" C/C	1/2" Center Bolt, 2 Holes, Ford
2	<b>SPA-8</b>	6"	3"	1"	.77"	.77"	3.06" C/C	1/2" Center Bolt, 2 Holes, Dodge

Call 800-233-0899 today to place your order.

Jim Musser  
Product Manager/Springs

Visit us on the World Wide Web at [www.daytonparts.com](http://www.daytonparts.com)

**Dayton Parts, LLC** • PO Box 5795 • Harrisburg, PA 17110-0795 • 800-233-0899 • Fax 800-225-2159  
**DP/Batco Canada** • 12390 184th Street • Edmonton, Alberta T5V 0A5 • 800-661-9861 • Fax 888-207-9064

To: Our Valued Dayton Parts Distributors

Subject: New drag link numbers

At Dayton Parts we're constantly updating our existing product lines with new additions. In this bulletin, we've added 13 new drag links to expand our coverage to newer applications. All of these are available and can be added to your next Dayton Parts Stock Order. See the new supplemental WD Price List P3BF2015-1(USA) or P3BF2015-2CAN(CANADA) for current pricing.

## DRAG LINK LENGTH CHART - Sorted by Dimensions

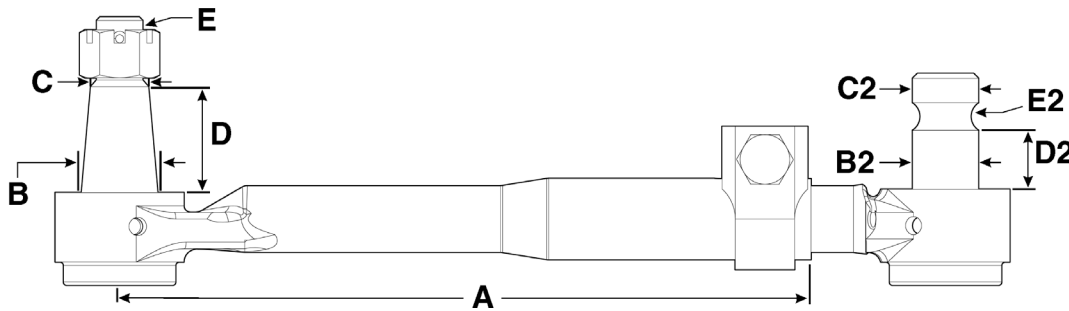

Length (A)	Part No.	Large Dia. (B)	Small Dia. (C)	Taper Len. (D)	Stud Thrd. (E)	Large Dia. (B2)	Small Dia. (C2)	Taper Len. (D2)	Stud Thrd. (E2)	End	Make	Remarks
13.13"	346-523	1.25	1.08	1.36	7/8-14	1.25	1.25	1.38	Lock-slot	1R	Mack	(310-435) C to E = 'A' Measurement

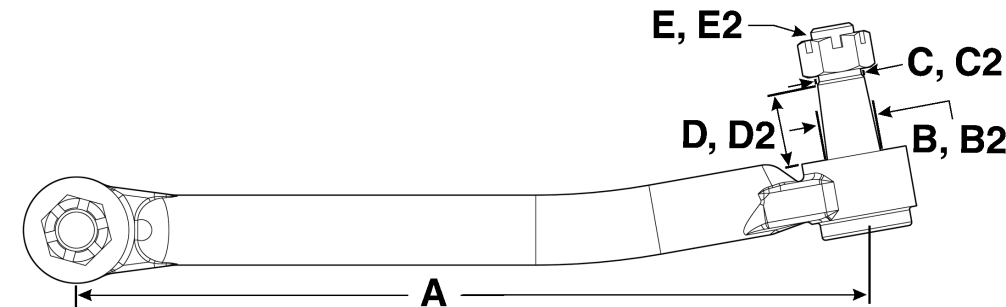

Length (A)	Part No.	Large Dia. (B)	Small Dia. (C)	Taper Len. (D)	Stud Thrd. (E)	Large Dia. (B2)	Small Dia. (C2)	Taper Len. (D2)	Stud Thrd. (E2)	End	Make	Remarks
16.40"	346-532	1.10	0.97	1.08	7/8-14	1.10	0.97	1.08	7/8-14	NR	IHC	

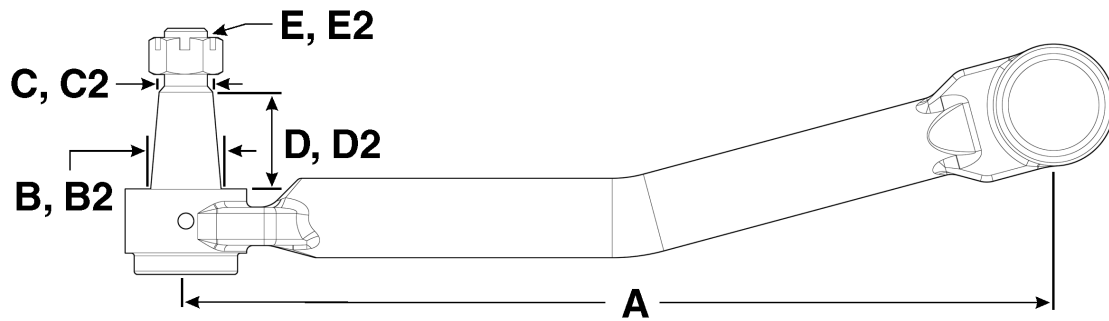

Length (A)	Part No.	Large Dia. (B)	Small Dia. (C)	Taper Len. (D)	Stud Thrd. (E)	Large Dia. (B2)	Small Dia. (C2)	Taper Len. (D2)	Stud Thrd. (E2)	End	Make	Remarks
18.28"	346-525	1.25	1.08	1.36	7/8-14	1.25	1.08	1.36	7/8-14	NR	Freightliner	

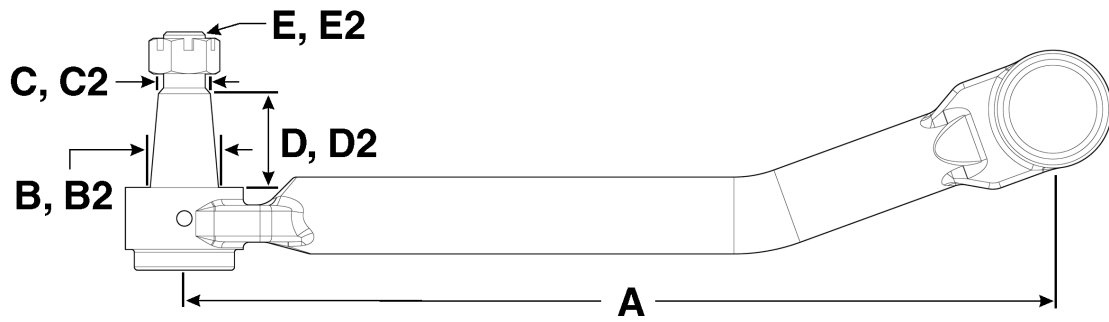

Length (A)	Part No.	Large Dia. (B)	Small Dia. (C)	Taper Len. (D)	Stud Thrd. (E)	Large Dia. (B2)	Small Dia. (C2)	Taper Len. (D2)	Stud Thrd. (E2)	End	Make	Remarks
18.85"	346-528	1.25	1.08	1.36	7/8-14	1.25	1.08	1.36	7/8-14	NR	Freightliner	

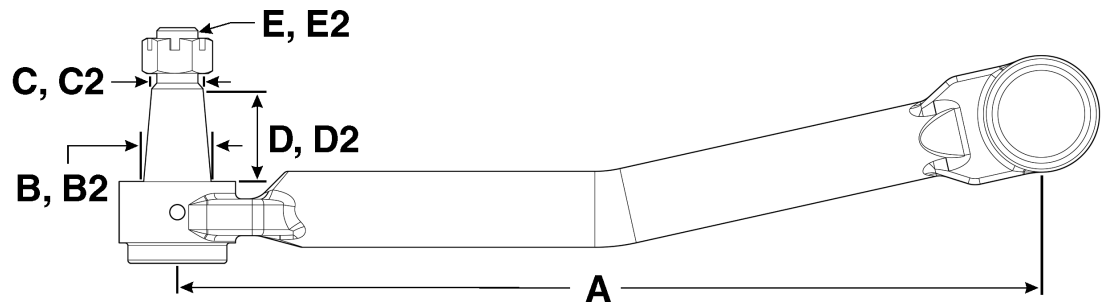

Length (A)	Part No.	Large Dia. (B)	Small Dia. (C)	Taper Len. (D)	Stud Thrd. (E)	Large Dia. (B2)	Small Dia. (C2)	Taper Len. (D2)	Stud Thrd. (E2)	End	Make	Remarks
18.92"	346-526	1.25	1.08	1.36	7/8-14	1.25	1.08	1.36	7/8-14	NR	Freightliner	

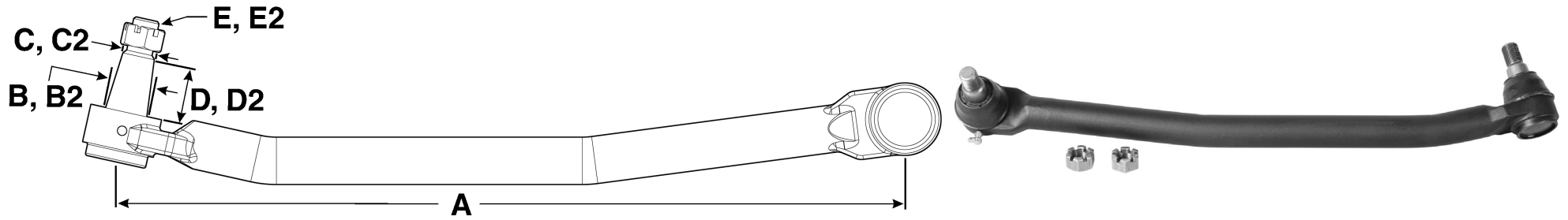

Length (A)	Part No.	Large Dia. (B)	Small Dia. (C)	Taper Len. (D)	Stud Thrd. (E)	Large Dia. (B2)	Small Dia. (C2)	Taper Len. (D2)	Stud Thrd. (E2)	End	Make	Remarks
27.53"	346-524	1.25	1.08	1.36	7/8-14	1.25	1.08	1.36	7/8-14	NR	Freightliner	

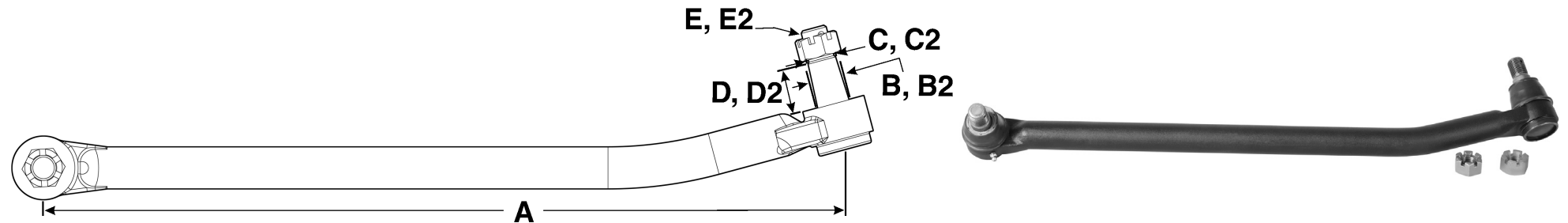

Length (A)	Part No.	Large Dia. (B)	Small Dia. (C)	Taper Len. (D)	Stud Thrd. (E)	Large Dia. (B2)	Small Dia. (C2)	Taper Len. (D2)	Stud Thrd. (E2)	End	Make	Remarks
28.06"	346-531	1.10	0.97	1.08	7/8-14	1.10	0.97	1.08	7/8-14	NR	IHC	

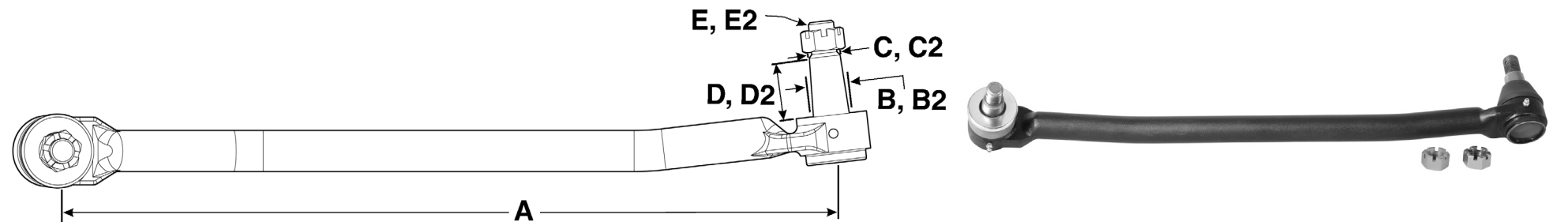

Length (A)	Part No.	Large Dia. (B)	Small Dia. (C)	Taper Len. (D)	Stud Thrd. (E)	Large Dia. (B2)	Small Dia. (C2)	Taper Len. (D2)	Stud Thrd. (E2)	End	Make	Remarks
28.19"	346-529	1.25	1.08	1.61	7/8-14	1.25	1.08	1.61	7/8-14	NR	IHC	

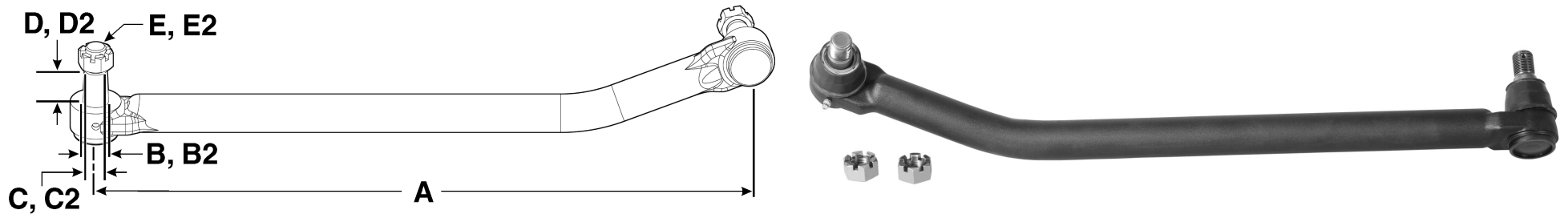

Length (A)	Part No.	Large Dia. (B)	Small Dia. (C)	Taper Len. (D)	Stud Thrd. (E)	Large Dia. (B2)	Small Dia. (C2)	Taper Len. (D2)	Stud Thrd. (E2)	End	Make	Remarks
28.28"	346-533	1.10	0.97	1.08	7/8-14	1.10	0.97	1.08	7/8-14	NR	IHC	

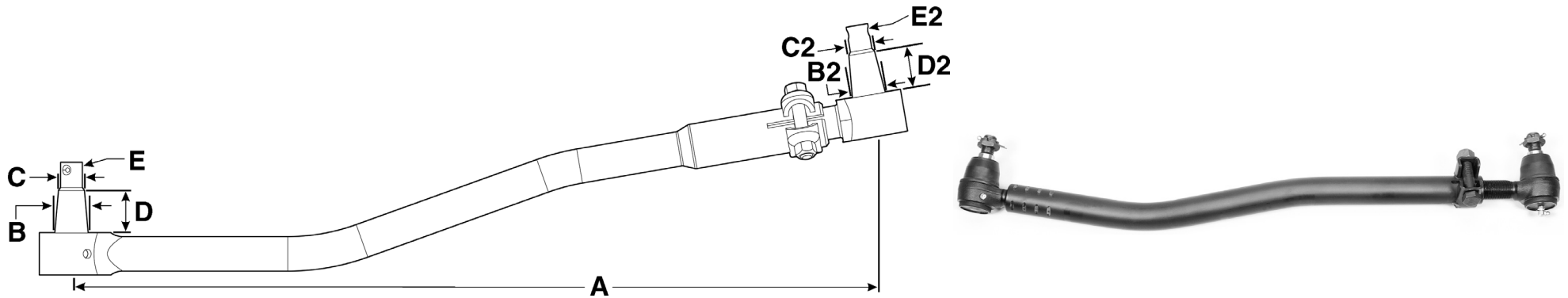

Length (A)	Part No.	Large Dia. (B)	Small Dia. (C)	Taper Len. (D)	Stud Thrd. (E)	Large Dia. (B2)	Small Dia. (C2)	Taper Len. (D2)	Stud Thrd. (E2)	End	Make	Remarks
28.67"	346-522	1.10	0.97	1.08	M20 x 1.5	1.13	0.99	1.10	M20 x 1.5	1R	Volvo/Mack	(310-444) C to E = 'A' Measurement

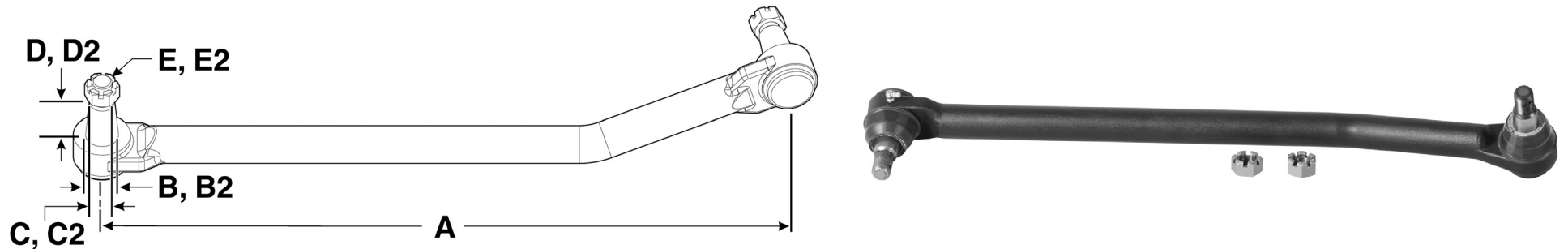

Length (A)	Part No.	Large Dia. (B)	Small Dia. (C)	Taper Len. (D)	Stud Thrd. (E)	Large Dia. (B2)	Small Dia. (C2)	Taper Len. (D2)	Stud Thrd. (E2)	End	Make	Remarks
30.28"	346-534	1.25	1.08	1.36	7/8-14	1.25	1.09	1.61	7/8-14	NR	IHC	

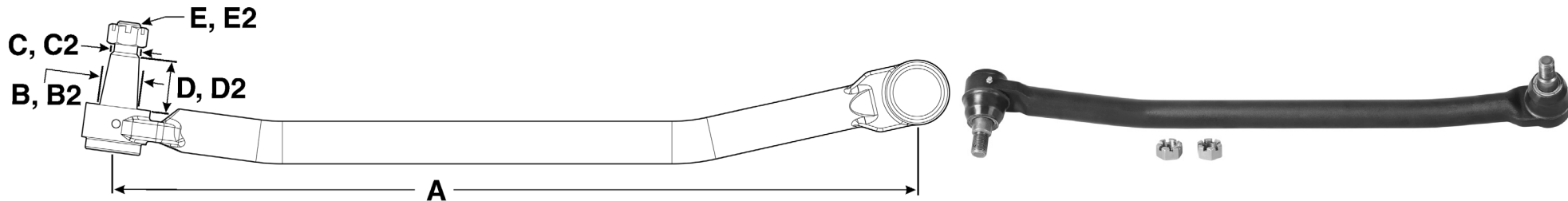

Length (A)	Part No.	Large Dia. (B)	Small Dia. (C)	Taper Len. (D)	Stud Thrd. (E)	Large Dia. (B2)	Small Dia. (C2)	Taper Len. (D2)	Stud Thrd. (E2)	End	Make	Remarks
31.47"	346-527	1.25	1.08	1.36	7/8-14	1.25	1.08	1.36	7/8-14	NR	Freightliner	

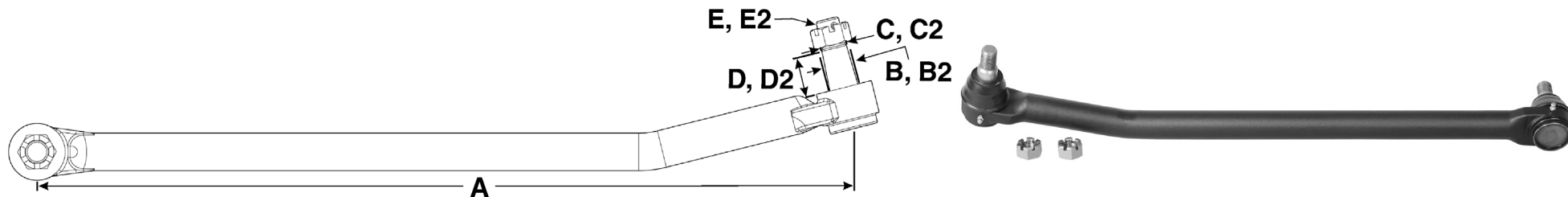

Length (A)	Part No.	Large Dia. (B)	Small Dia. (C)	Taper Len. (D)	Stud Thrd. (E)	Large Dia. (B2)	Small Dia. (C2)	Taper Len. (D2)	Stud Thrd. (E2)	End	Make	Remarks
31.75"	346-521	1.25	1.08	1.36	7/8-14	1.25	1.08	1.36	7/8-14	NR	Freightliner	

**Replacement End:** NR = Non-Replaceable / 1R = 1 Replaceable End / 2R = 2 Replaceable Ends

Call 800-233-0899 today to place your order.

*Steven S. Wolf*

**Steven S. Wolf**  
Axle Group Product Manager

Visit us on the World Wide Web at [www.daytonparts.com](http://www.daytonparts.com)

**Dayton Parts, LLC** • PO Box 5795 • Harrisburg, PA 17110-0795 • 800-233-0899 • Fax 800-225-2159

**DP/Batco Canada** • 12390 184th Street • Edmonton, Alberta T5V 0A5 • 800-661-9861 • Fax 888-207-9064