

TRUCKSTOP

GROUP

COMMERCIAL NEWSLETTER



Redditch Branch Tel: 01527 68279

Birmingham Branch Tel: 0121 647 3790

Worcester branch Tel: 01905 758600

E-Mail: enquiries@truckstopgroup.co.uk

www.truckstopgroup.co.uk

www.tec-stop.co.uk

www.lightbarsdirect.co.uk

See Inside For News, Offers & Promotions...

EURO 5



**EURO 5 SILENCERS
NEXT DAY
DELIVERY**



DAF CF & XF



**Part No. 22312
OE no. 1827548**



**Part No. 21448
OE no. 1827549**



**Part No. 21441
OE no. 1827547**

Iveco Stralis & Trakker



**Part No. 28461
OE no. 41298535, 41272365**



**Part No. 28477
OE no. 41298536, 41299218**



MAN TGA / S / X



**Part No. 47333
OE no.
81.15103.6037
81.15103.0039**



**Part No. 47335
OE no.
81.15103.6038**

**Part No. 47340
OE no.
81.15103.0094
81.15103.6059**

**Part No. 47330
OE no.
81.15103.0026
81.15103.0035**



EURO 5



EURO 5 SILENCERS NEXT DAY DELIVERY



Mercedes Actros & Axor



Part No. 51340
OE no. 004.490.0014
001.490.0014, 002.490.0014
005.490.0714, 005.490.1614
002.490.6514

Part No. 51358
OE no. 004.490.0114
001.490.0114, 002.490.0114
005.490.0814, 000.490.5014
000.490.8814

Part No. 51360
OE no. 001.490.0514
004.490.0514, 002.490.0514
004.490.8114

Part No. 51363
OE no. 004.490.0414
001.490.0414, 002.490.0414
004.490.8014

Scania P / G / R Series



Part No. 68343
OE no. 1548344 , 1914724
1944683

Part No. 68350
OE no. 1548340

Volvo FM / FH & Renault Premium / Magnum & Kerax



Part No. 80377
OE no. 20579349

Part No. 80389
OE no. 20579348

Part No. 80389
OE no. 20579348



CP7500D - Small Angle Grinder 2 Inch
£98.50 + VAT



1250 Nm

CP7748 - 1/2 Inch Impact Wrench
£152.50 + VAT



2900 Nm

CP7782-6 - 1" Straight impact wrench with a 6" anvil
£399.50 + VAT



1898 Nm

CP797-6 - 1" Extended Impact Wrench
£475 + VAT



CP9789 - 1/2" Pistol Grip Air Drill
£96.07 + VAT



610 Nm

CP7732 - 1/2" Stubby Impact Wrench
£110.00 + VAT



CP7110 Kit - Heavy Duty Air Hammer Kit
£65.00 + VAT



1420 Nm

CP7762 - 3/4" Stubby Impact Wrench
£249.99 + VAT



1627 Nm

CP7763 - 3/4" Impact Wrench
£275.00 + VAT



CP7828 - 3/8" Air Ratchet
£108.00 + VAT

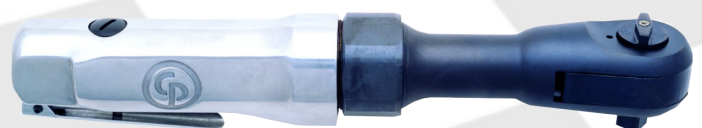

CP828 - 3/8" Heavy Duty Air Ratchet
£95.00 + VAT

Parker

Racor

Now available from Truckstop Group is the Parker Racor range of filters and filter assemblies. Traditionally the filter assemblies were always classed as dealer only parts. Now you can get the same OE quality at Aftermarket prices from Truckstop. Below is an example of some of the range we can supply - For more information or to place an order call your local branch.



Volvo FH 16 Fuel Euro 6
Complete Assembly
Electric pump
OE No. 21762800
Part No. DRK00431



Mercedes Atego / Axor Euro 4/5
Complete Assembly with 12/24v
Heater
OE No. A 000 470 04 69
Part No. 4160RHHV10MTC-SLV



Scania 4/G/P/R/T Euro 4/5
Complete Assembly with bowl
heater
OE No. 1393642
Part No. 690-30M-24



Scania 4/G/P/R/T Euro 4/5
Complete Assembly without
heater
OE No. 1393639
Part No. 690-30M M16



Iveco Stralis / Trakker Euro 5
Complete Assembly integrated water
sensor, no heater
OE No. 5041 01 411
Part No. 490RP10-D-01



Renault Midlum II
Complete Assembly, water
sensor, 12/24v heater
OE No. 74 21 088 121
Part No. MD5760DTV30RCR02

COAST™

LIGHTS • KNIVES • MULTI-TOOLS

INSPECTION BEAM POCKET LIGHT INSPECTION BEAM - 72 FT BEAM - 1 X AAA

Only
£9.95
+ VAT



Part No.: COA20910A

INSPECTION BEAM

The Inspection Beam produces an incredibly clear and consistent beam from edge to edge making up close work or activities easier. Found on a variety of our penlights, the beam is capable of illuminating a defined area up to 30 feet (9 meters).

The G9 Flashlight features our Inspection Beam Optic that gives users a perfectly circular beam that has little glare, making optimal for up close work. Due to its small size and weight, it is an excellent choice for an everyday carry item. The light also possesses the versatility of a two-way clip, which allows for users to clip to a pocket or a bill of a hat. Built for ease of use, the light is activated by just twisting the end cap.

With Coast's commitment to quality, the G9 Flashlight is impact resistant, weather resistant and its LED is virtually unbreakable. The G9 Flashlight is backed by Coast's lifetime warranty against defects in materials and workmanship.

RECHARGEABLE LONG DISTANCE FOCUSING - 300 LUMENS - 1154 FT BEAM - LI-ION PACK OR 4 X AAA

Only
£59.95
+ VAT



Part No.: COAHP7R

LONG RANGE FOCUSING OPTICS

The Long Range Focusing Optic gives you the ability to easily illuminate and scan nearby distances with a crisp edge-to-edge Broad View Flood Beam or then focus it down to the X-Range Spot Beam that stretches extremely far. The X-Range Spot Beam can provide good viewing all the way up to 2240 feet (683 meters) and the Broad View Flood Beam provides a consistent circle of light up to 7 1/2 feet (2.3 meters) in diameter at a distance of 6 feet (1.8 meters).

The HP7R Flashlight is the ultimate light for any law enforcement official or serious professional by combining our Long Range Optic System with slide focus and a lightweight aluminum body. With our Flex Charge Dual Power system, this light harnesses either lithium or alkaline power and using a micro USB, you can recharge the batteries either in or out of the light. With high, strobe and low modes with the slide focus, this light is immediately adaptable to a variety of situations.

With Coast's commitment to quality, the HP7R Flashlight is impact resistant, weather resistant and its LED is virtually unbreakable. The HP7R Flashlight is backed by Coast's 5 year warranty against defects in materials and workmanship.

PURE BEAM FOCUSING 410 LUMENS - 751 FT BEAM - 4 X AAA

Only
£39.95
+ VAT



Part No.: COAHP7RPLUS

PURE BEAM FOCUSING OPTICS

The Pure Beam Focusing Optic combines our largest Ultra View Flood Beam with the Bulls-Eye Spot Beam making either up close or downrange illumination highly effective. While using the Ultra View Flood Beam, there is a consistent circle of light up to 11.5 feet (3.5 meters) in diameter at 6 feet (1.8 meters) in distance. While on the Bulls-Eye Spot Beam, you can illuminate up to 767 feet (234 meters) downrange with a transition halo around the spot to increase the effective viewing area.

A perfect mix of size, form, and performance, the HP7 Flashlight is rightfully one of our most popular handheld lights. It combines our Pure Beam Focusing System with Slide Focus with high, medium, and low output modes to illuminate with either a super wide flood beam or spot mode with transition halo at varying distances and brightness all controllable with one hand. It's anti-roll tailcap allows you to set it on uneven surfaces without rolling off and it even allows you to stand the light up on its cap for vertical lighting situations.

With Coast's commitment to quality, the HP7 Flashlight is impact resistant, weather resistant and its LED is virtually unbreakable. The HP7 Flashlight is backed by Coast's 5 year warranty against defects in materials and workmanship.

0-776-62 12/24V
**720P DUAL
DASH CAMERA**

DURITE



HD 720P Dual Dash Camera with
GPS- 12V/24V

Forward & rear facing dual dash camera. 140° (front) 120° (rear) view angle camera with 2.7" LCD screen - provides a high definition recording of 1280 x 720 pixels. Built-in microphone & speaker.

- ⇒ Forward facing & interior camera
- ⇒ Continuous recording with date & time stamping
- ⇒ Automatically records when vehicle starts
- ⇒ Quick release windscreen suction mount
- ⇒ GPS to pin point location & speed monitoring
- ⇒ Built-in G-sensor, locks recording in case of incident

**Special Offer Only £99.50 Each + VAT Or
£94.50 Each In 4s**



**Full HD 1.5" Dash
Camera with GPS**
0-776-60 12/24V

Dash-mounted 3 megapixel, 170° view angle camera with 1.5" screen and audio function - provides a shooting resolution rate of FHD 1920 x 1080 & HD 1280 x 720. 2 level password protection.

- Automatically powers on and off with the vehicle engine, with loop recording.
- Manual video recording, photographic and motion detection functions.
- Built-in collision sensor (G-sensor) which locks recording.
- Comes with USB cable and 12V/24V cigarette cable/plug.
- 2 fitting options: Stick on windscreen or suction pad (supplied)
- Output video shows date and time, location via GPS, vehicle speed & G force.

If a vehicle is allocated to a specific driver, this will count as personal information under data protection law - Data Protection Act 1998.



**Special Offer Only £99.50 Each + VAT Or
£94.50 Each In 5s**

TRUCKSTOP

GROUP

**THE MIDLANDS BIGGEST
AIR BRAKE CENTRE**



WABCO

S A F E T Y D R I V E S U S

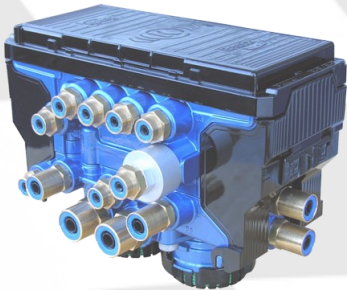

We are delighted to announce we are now distributors for Knorr-Bremse. They will sit along our existing accounts with Haldex and Wabco and it means that Truckstop is the number one choice for air brake components. With our expanding stock, knowledgeable staff, three branches and same day delivery trust Truckstop as your air brake specialist.



NEW! Wheel Nut Cover Reflector Indicator

Reflector Indicator

The reflector indicator is aiming for more safety in traffic, specifically for the traffic in the blind spot area of busses and trucks.

The reflector is part of the cover which also functions as a wheel nut loosening indicator

Retro-reflection material is used on the top of the cap to reflect the light towards other road users

When the steering axle wheels of the vehicle start to turn, the light from the cover reflects and then allows other road users to act quickly.

Available in nut size 32mm and 33mm

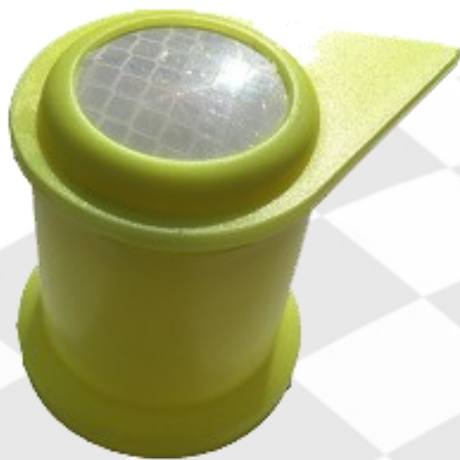

Conspicuity Tape

From July 2011, all newly registered HGVs over 7.5 tonnes and trailers over 3.5 tonnes must have reflective conspicuity markings that clearly outline the rear and sides of the vehicle to make it visible for up to 1000 metres at night. ECE104 specifies the standard for the reflective materials used, and where and how it must be positioned on the vehicle or trailer.

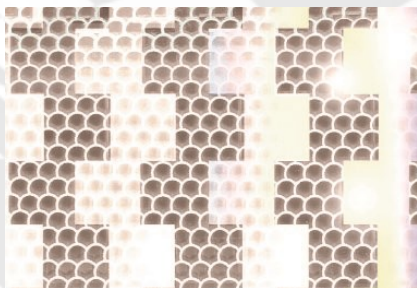

Part Number
CTEC104W-12.5M
12.5 Metre Roll - White
CTEC104W-50
50 Metre Roll - White

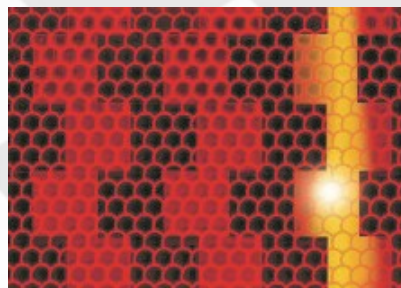

Part Number
CTEC104R-12.5M
12.5 Metre Roll - Red
CTEC104R-50
50 Metre Roll - Red



Part Number
CTEC104A-12.5M
12.5 Metre Roll - Amber
CTEC104A-50
50 Metre Roll - Amber

All Conspicuity Tape can now be personalised with your Company logo - Phone for details



FREE FLEECE JACKET WHEN YOU BUY A SACHS CV CLUTCH KIT



Offer runs from publication until the 28/02/2018 subject to availability.

Sizes available are Medium to XL only.



AdBlue®

Filters



DAF, Iveco, MAN, Scania
Part No. 3967874
£26.03 + VAT
VAT



Dennis, Iveco, Renault, Volvo
Part No. 3986767
£27.85 + VAT



DAF, Isuzu, Iveco, Renault, Volvo
Part No. UF101
£32.37 + VAT

AdBlue Caps



All Priced at £19.95 + VAT

To fit DAF - CF75, CF85, XF105, MAN
- TGA, TGL, TGM, TGS, TGX, MER-
CEDES - Actros, Atego, Axor, Sprint-
er Fitment type: 40mm

O.E. No 0004701805, 0004702705,
01903600

Part No. TAC001

To fit IVECO Stralis

O.E. No: 41298191, 26300027200,
12901600A

Fitment type: 60mm - Plastic Bayonet

Part No. TAC002

To fit SCANIA - various

O.E. No: 21075531, 1759435

RENAULT - various

O.E. No: 20926022

VOLVO - various

O.E. No: 21075528

IVECO - various

O.E. No: 41298121

60mm, Locking

Part No. TAC003



Hella LED Work Light
1500 Lumens Close-range illumination, power requirement: 15 watts, protection class: IP 6K9K (high-pressure cleaner compatible), ECE-R10 approval
1GA-357-103-022
L x 100 x W x 420 x H 129mm
£24.50 + VAT



Durite 10-40V LED Flood Light with 6 x 3 watt CREE LEDs. This LED Work lamp may be small but it makes up for it by producing an extremely bright, crisp light at an intensity of approx. **1500 lumens**
0-420-78
L x 76 x W x 42 x H 90mm
£23.50 + VAT



The **E92007** worklamp offers the latest technology and the very brightest white light.. This LED model offers over **80,000 hours** of maintenance free life expectancy. Permanent mount. CE. IP67, RoHS
550 Lumens
L x 110 x W x 46 x H 135mm
£19.50 + VAT



A super powerful 9 x 5W 12V/24V work lamp with OSRAM LEDs. 300mm fly lead. Protected to IP68.
3150 Lumens.
0-420-81
L 109 x W 70 x H 135mm.
£29.95 + VAT



Amber 2ft 104 LED Light Bar - 12V/24V
0-443-40 - £185 + VAT

Amber 2ft 104 LED Light Bar - 12V/24V

2ft (760mm) Amber LED light bar with 104 SMD LEDs. Max power 52W. 10 Flash patterns including (double) ECE R65 approved. Waterproof to IP67. Bolt mounted with adjustable feet.
L 326 x W 760 x H 81mm (with bracket). E-marked, ECE R10.



Amber 4ft 152 LED Light Bar - 12V/24V
0-443-42 - £245 + VAT

4ft (1200mm) Amber LED light bar with 152 SMD LEDs. Max power 76W. 10 Flash patterns including (double) ECE R65 approved. Waterproof to IP67. Bolt mounted with adjustable feet. L 326 x W 1200 x H 81mm (with bracket). E-marked, ECE R10.

DAF XF Euro 6

2014 on

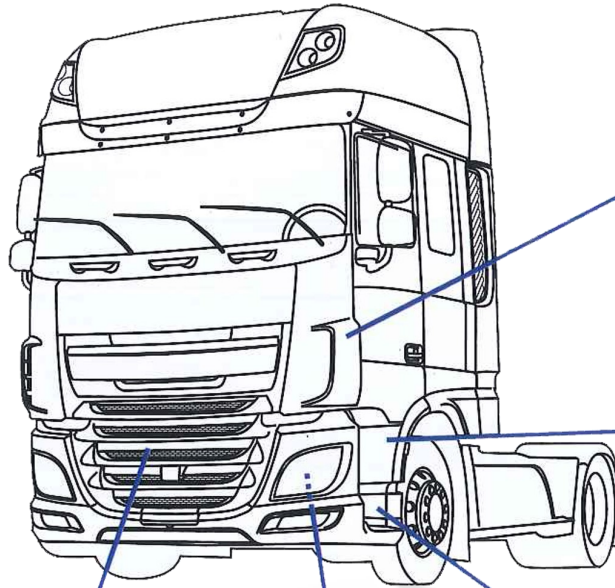

CVNXF6160 RH
CVNXF6161 LH

£130.00

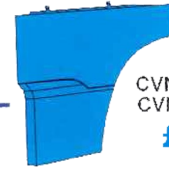

CVNXF64 RH
CVNXF65 LH

£128.00



CVNXF6100 RH
CVNXF6101 LH

£99.00

£210.00 CVNXF6150

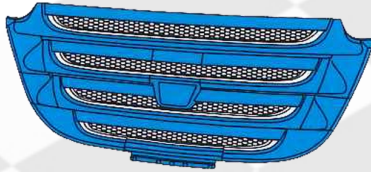

CVNXF698 RH
CVNXF699 LH

£67.00

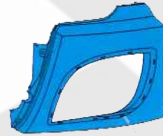

CVNXF688 RH
CVNXF689 LH

£36.00

CVNXF6115 **£9.00**



CVNXF690 **£140.00**

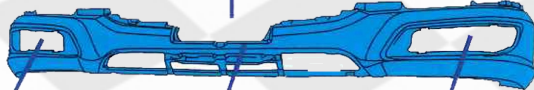

CVNXF694
£14.00



CVNXF695
£14.00



CVNXF6105
£11.80



CVNXF6200 RH
CVNXF6201 LH

£140.00

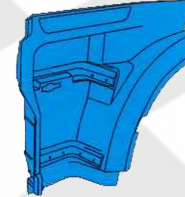

CVNXF6214 RH
CVNXF6215 LH

£27.50

CVNXF6230 RH
CVNXF6231 LH
£8.00



CVNXF6240 RH
CVNXF6241 LH
£28.50

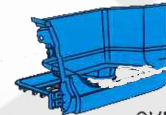

TRUCKSTOP

GROUP

All prices subject to VAT

EXOPRO

FIND A GOLDEN TICKET

IN ALL PROMOTIONAL EXOPRO LUBRICANT BARRELS PURCHASED
FROM 13TH NOVEMBER 2017 TO 31ST MARCH 2018*

500 PRIZES TO BE WON!

LOOK OUT FOR THE
GOLD BARREL
CAPS!



EXOPRO lubricants are exclusively available
from your local **UAN** Factor,
please visit www.exopro.co.uk
for further details.

* While Stocks Last. Images are for illustration purposes only.
Please visit www.exopro.co.uk for full terms and conditions.

EXOPRO Available from:

TRUCKSTOP

GROUP



Battery Master Switch
MBS1-1 - £4.95

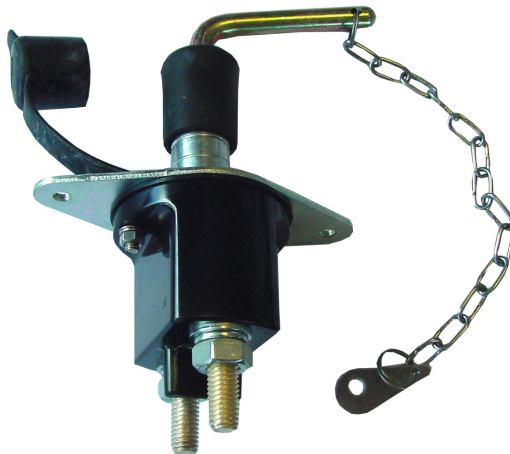

Heavy Duty Battery Master Switch
MBS3-1 - £15.50



Heat Shrink Butt Connectors
THR135 Red - £0.16
THB235 Blue - £0.17
THY335 Yellow - £0.25

Cable Offers



| Type Of Cable | Part Number | Length | Core | Size(mm) | Amps | Offer Price |
|---------------|-------------|--------|------------------------|------------|--------------|-------------|
| THIN WALL | CTW012-100B | 100M | 32/0.20 | 1.0 | 16.5 | £12.50 |
| THINWALL | CTW013-100B | 100M | 30/0.25 | 1.5 | 21.0 | £22.50 |
| TWIN CORE | C202-100BRB | 100M | 2x14/0.30 | 2x1.0 | 8.75 | £34.50 |
| TWIN CORE | C204-30BRB | 30M | 2x28/0.30 | 2x2.0 | 17.5 | £19.95 |
| SEVEN CORE | C702-30B | 30M | 6x14/0.30 1x28/0.30 | 1.0 2.0 | 8.75 17.5 | £42.50 |

All Prices Subject To VAT

TEC→STOP

DIAGNOSTICS

We are pleased to announce the launch of the new Tec-Stop diagnostics website.

You will find our latest diagnostic products for Car, Truck, Bike & Agricultural vehicles on the website - all available to buy online.

Alongside the vehicle diagnostics there is also air conditioning service equipment, emissions analysers, oscilloscopes, diesel test equipment and even workshop cleaning equipment.

You can also check out all the training courses and programmes we have available from Texa, Delphi and Bosch plus our latest news articles.

www.tec-stop.co.uk

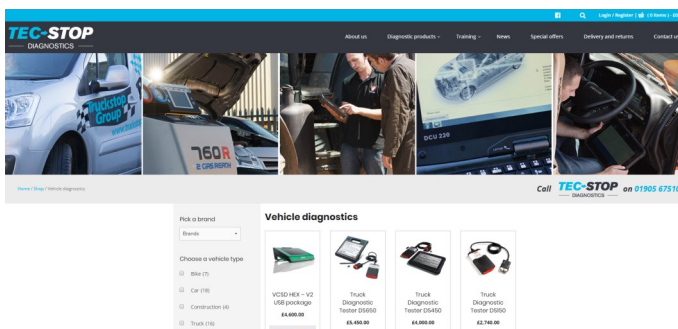
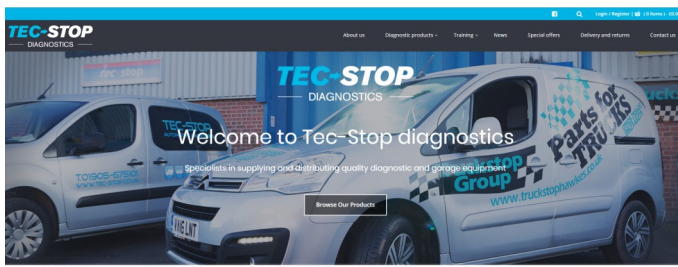

All Prices Listed Subject To VAT - All Offers Available Until The End Of October Or While Stocks Last

TRUCKSTOP
GROUP

Birmingham Branch, Unit 14 Burhill Way Ind Est, Chelmsley Wood, Birmingham B37 6RF
Tel: 0121 647 3790

Redditch Branch, Unit 9 Brook Street, Lakeside, Redditch, Worcs. B98 8NG
Tel: 01527 68279

Worcester Branch, Unit 87a Blackpole West Trading Estate, Worcester, WR3 8TJ
Tel: 01905 758600

Web: www.truckstopgroup.co.uk
E-Mail: enquiries@truckstopgroup.co.uk