

ENGINEERED SOLUTIONS

o f G e o r g i a

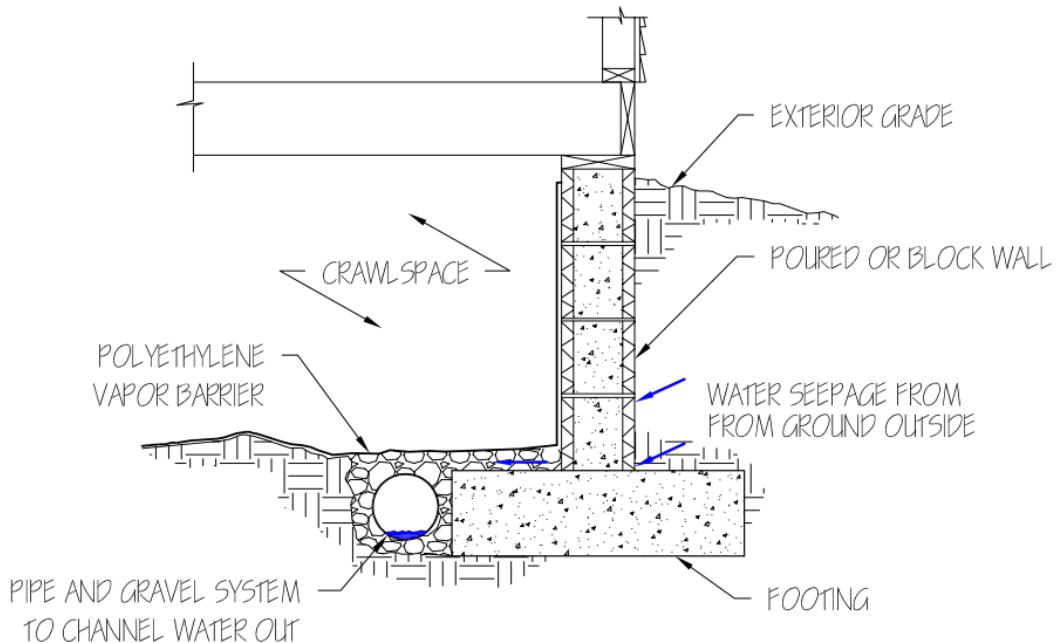

Encapsulation Systems



**ENGINEERED
SOLUTIONS**
o f G e o r g i a



Encapsulation

A crawl space encapsulation from Engineered Solutions of Georgia offers a homeowner many benefits, including:

- Lowers energy bills
- Eliminates musty smells and odors inside your home
- Reduces moisture and humidity, lessening the chance of structural damage to your home
- Keeps pests out
- Provides cleaner, healthier air inside your home
- Prevents water from seeping into your crawlspace with a variety of [waterproofing](#) techniques

At Engineered Solutions, we are proud to offer homeowners the expert advice they need when it comes to a variety of [house foundation repair](#) needs, [basement waterproofing techniques](#), and more, especially crawl space encapsulation. This emphasis on customer care has earned us a large number of recommendations from previous clients who are extremely satisfied with the reliable, professional work we have done for them.





Encapsulation Systems

- Encapsulation and Drain
- Encapsulation Only
- Santa Fe Dehumidifier

Click on this image to watch a video on Encapsulation installation

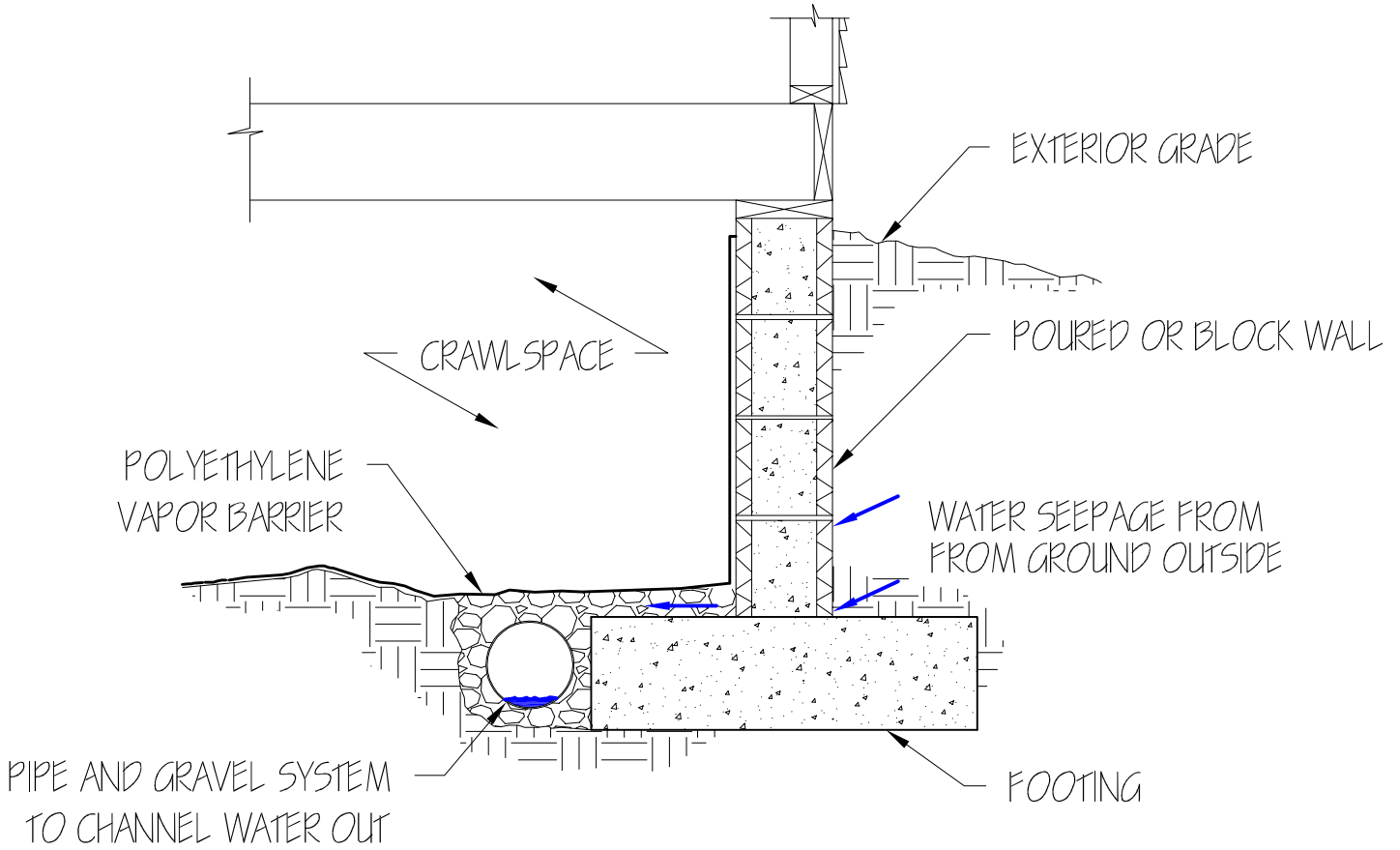

ENCAPSULATION

DRAWN BY	KS
SCALE	N/A
DATE	4/6/07
DRAWING #	SKI

ENGINEERED SOLUTIONS
of Georgia
Foundation Repair & Waterproofing

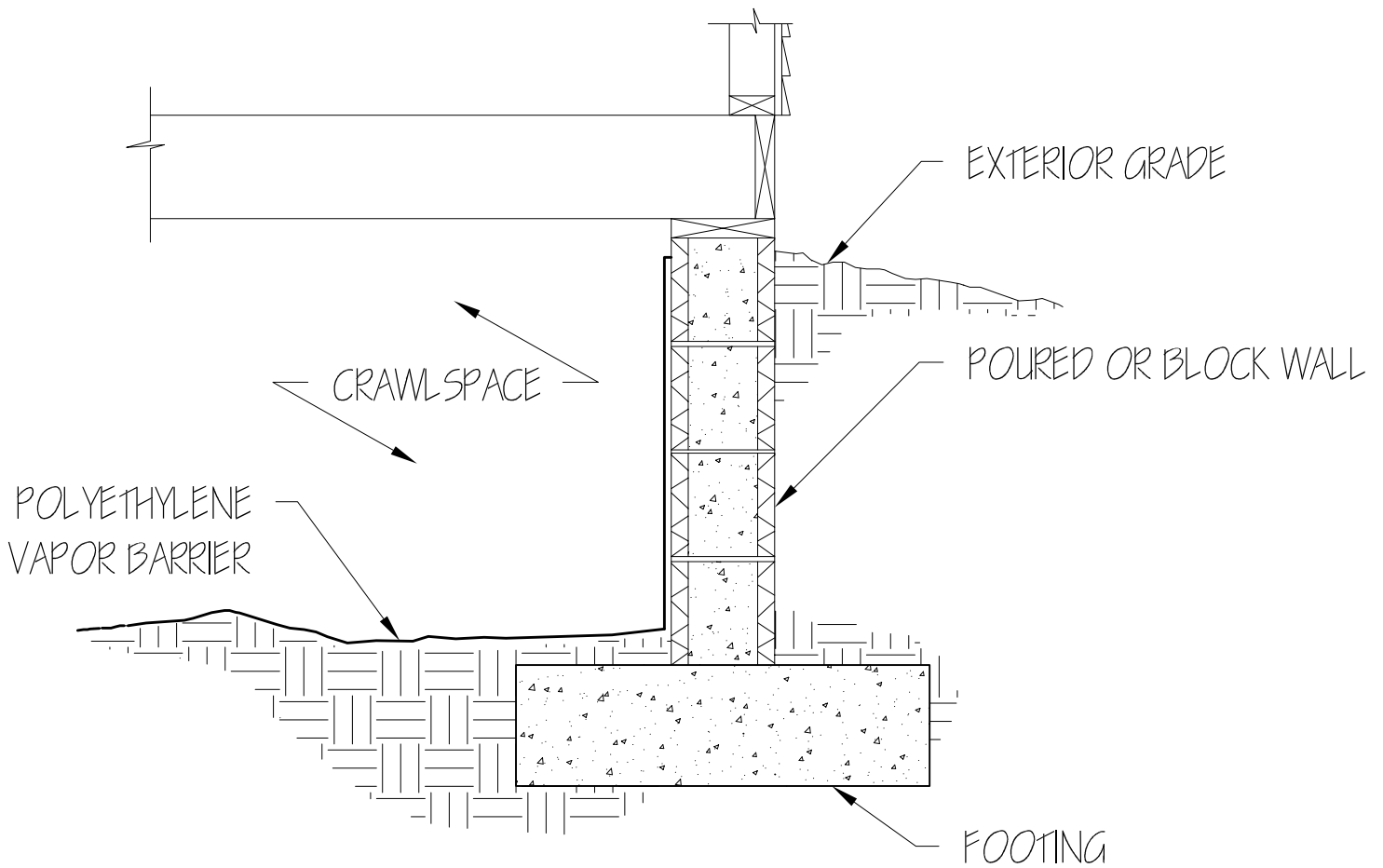

ENCAPSULATION ONLY

DRAWN BY

KS

SCALE

N/A

DATE

12/18/07

DRAWING #

SKI

**ENGINEERED
SOLUTIONS**

of Georgia

Foundation Repair & Waterproofing





The ESOG Advantage

click on each icon to see more information



Guildmaster Award 2014, 2015
Service Excellence Award 2012, 2013
Best of Awards 2011, 2012, 2013, 2014



Contractor Award
Best of 2012, 2013, 2014, 2015



Super Service Award
2010, 2011, 2012, 2013, 2014



Verified Foundation Repair Contractor
2010, 2011, 2012, 2013, 2014, 2015



Five Star Rated Contractor
2010, 2011, 2012, 2013, 2014, 2015



Preferred Contractor
2010, 2011, 2012, 2013, 2014, 2015

ENGINEERED SOLUTIONS

of Georgia

Foundation Repair & Waterproofing



Studies have shown that as much as 50% of the air in your home comes up from your basement or crawlspace. This air is often higher in moisture content and carries with it various allergens and musty odors. When conditions linger above 60% relative humidity for extended periods of time, mold, mildew, and bacteria growth is stimulated.

The American Lung Association, American Medical Association, and the EPA recommend maintaining relative humidity levels in the 30% - 50% range. Ventilation and air conditioning alone cannot provide the protection offered by a high capacity dehumidifier like the Santa Fe Impact XT.™ Protecting your family and your biggest investment is worth the best.

"Application-Specific" Design

The Santa Fe Impact is specifically designed to dramatically impact the moisture in your crawlspace/basement, your energy bills and the environment. It is the most energy efficient dehumidifier on the market - exceeding ENERGY STAR® standards by 50 percent. The Santa Fe Impact removes up to 105 pints of water a day while using an unprecedented 4.9 amps (8.8 pints per Kilowatt hour). It effectively dehumidifies up to 2,500 square feet and is the ideal free-standing dehumidifier for meeting aggressive energy use targets. The unit is engineered for extreme quiet operation and is optimized for low heat load. Optional condensate pump and ducting kits provide the installation flexibility necessary for the most challenging applications.

- **High Efficiency** – The **MOST** energy-efficient large capacity residential dehumidifier on the market.
- **Large Capacity** – The high capacity provides 105 pints per day of water removal at standard rating conditions*. Large-sized basements and crawlspaces (up to 2500 sq. ft.) are no problem for the Impact.
- **Low Temperature Operation** – Engineered for the temperature and air flow issues that surface in crawlspaces and basements. When many conventional dehumidifiers have stopped removing water, the Santa Fe Impact continues to protect your family and your home.
- **Superior Air Filtration** – MERV-11 filtration is standard, capturing particles (including mold spores) down to 1 micron in size. This superior level of air filtration keeps the Impact working at peak efficiency while cleaning the air.
- **Auto Restart** – Santa Fe dehumidifiers will automatically restart at the original setting after a power outage.
- **Optional Equipment** – Ducting kits and condensate pumps are available for use with the Santa Fe Impact. These optional kits provide the ultimate in flexibility for your specific installation requirements.

Consequences of High Humidity

- The ground in a crawlspace or under the basement slab remains at a near constant temperature of 50-60°F year round. These cool surface temperatures create micro-environments where the relative humidity of the air approaches its saturation point (100%RH) and condensation (or sweating) can occur. The conditions that result support mold/microbial growth and cause musty odors.
- Crawlspaces and basements are a major source of air infiltration that permeates up into the living area, transmitting odors, carrying moisture, and creating an environment conducive to molds, pests, and dust mite infestation.
- Wet crawlspaces and basements contribute to the cupping of wood floors and the deterioration of floor joists, beams, sub-flooring, insulation, and electrical-mechanical systems.
- Excess moisture encourages mold growth on wood and on any other organic material in a crawlspace.

Large Capacity Dehumidification with Dual Air Distribution

Capacities for residential dehumidifiers are measured in pints of water removed per day at standard conditions (80°F and 60% RH) determined by the American Home Appliance Manufacturers (AHAM). At these conditions, the capacity of the Santa Fe Impact is 105 pints per day, while most standard residential units range from 20 to 65 pints of water removal per day. However, most basements and crawlspaces are cooler than 80°F and therefore the water removal capacity of the standard residential unit will be diminished significantly.

A large capacity dehumidifier is necessary to ensure that enough moisture is removed at the real-world temperature of your crawlspace or basement to prevent mold, mildew and bacterial growth. The Santa Fe Impact is a large-capacity dehumidifier designed for these cooler applications.

*American Home Appliance Manufacturers (AHAM) standard testing conditions are 80°F and 60% RH.

Performance and Technical Specs

Part Number:	4032230
Blower:	257 CFM @ 0.0" WG
Power:	530 watts @ 80°F and 60% RH
Supply Voltage:	115 volt – 1phase – 60 Hz
Current Draw:	4.9 amps
Operating Temp.:	56°F Min., 95°F Max.
Sized for:	2,500 Sq. Ft. - Typical



Minimum Performance at 80°F and 60% RH

Water Removal:	105 Pints/Day	
Efficiency:	8.8 Pints/kWh	
Energy Factor:	4.2 L/kWh	
Air Filter:	MERV-11, Standard Pleat	
Size:	16" x 20" x 2"	
Power Cord:	10', 115 VAC, Ground	
Drain Connection:	3/4" Threaded Female NPT	
Drain Hose:	5/8" ID x 8' Direct Gravity Drain Hose	
Refrigerant Type:	R410A (Refer to manufacturers label for more information)	
Refrigerant Amount:	1lb. 13 oz.	
Dimensions:	Unit	Shipping
Width:	20.25"	25"
Height:	21.75"	28"
Length:	38"	42"
Weight:	140 lbs.	156 lbs.

The Santa Fe Impact is the most energy efficient dehumidifier on the market - exceeding ENERGY STAR® standards by 50 percent.

Optional Accessories

4021475	MERV 11 Filter (16x20x2)
4027420	MERV 11 Filter 4-Pack
4027424	MERV 11 Filter 12-Pack
4028614	Pump Kit
4028616	Caster Kit
4028607	Duct Kit, Supply Only
4028610	Duct Kit, Return Only
4026969	10" Flex Duct 25'
4022126	10" Flex Insulated Duct 25'
4028610	Duct Kit, Return Only
4024750	12" Flex Duct 25'
4028366	12" Flex Insulated Duct 25'
4020175	Remote Dehumidistat

The Santa Fe Impact is specifically designed to dramatically impact the moisture in your crawlspace/basement, your energy bills and the environment.

Remote Hygrometer



4029577

Displays indoor and outdoor temperature, relative humidity, moon phases, time and date.

Wireless sensor with low temperature adaptor included.

CRAWLSPACE ALERT™



4030280

Works remotely with your Santa Fe Dehumidifier to provide a warning light when humidity levels are too high in the crawlspace and will automatically turn off the dehumidifier if the overflow safety switch is tripped on the condensate pump.



One of the best Limited Warranties in the industry today –
 2 YEARS – All Parts and Labor
 5 YEARS – Sealed Refrigeration System



NAHB
 NATIONAL ASSOCIATION OF HOME BUILDERS



**ENGINEERED
SOLUTIONS**

o f G e o r g i a



**Corporate office
2260 Northwest Parkway
Suite H
Marietta, GA 30067
678-290-1325 - office
770-956-7403 – Fax
www.esogrepair.com**