

# BITS

STRICTLY TRADE ONLY

OFFERS VALID UNTIL  
31<sup>st</sup> AUGUST 2017



ANY PART FOR ANY CAR  
OVER 200 BRANCHES NATIONWIDE

**QUKO**  
CAR PARTS

socefi GROUP



# FRAM®

## 85 YEARS OF ORIGINAL PERFORMANCE!

**ESTABLISHED IN 1932**, the **FRAM®** name is synonymous with original performance, for the Independent Aftermarket. The Fram brand provides the customer with filters that satisfy the vehicle manufacturers' requirements.

Today's advanced vehicle engines are set to tighter tolerances and rely on top quality filtration. With **OE QUALITY** oil, air, fuel and cabin filters **FRAM®** offers a complete choice for every customer. **FRAM®** provides high quality filtration media and drives innovation, including high efficiency water separation (**DIESEL3TECH™**) and low restriction media.

To achieve this, the manufacturing team has acquired over 85 year's expertise to adapt pleating technics to these state of the art filtration materials.

All the major players in passenger cars, industrial, railway, agricultural and earth moving applications have confidence in Sogefi Group expertise.

*Alfa Romeo, Aston Martin, Audi, Bmw, Chrysler, Citroën, Ferrari, Fiat, Ford, General Motors, Honda, Lancia, Land Rover, Maserati, Mercedes-Benz, Mitsubishi, Nissan, Peugeot, Renault, Seat, Skoda, Toyota, Volkswagen, Volvo*

**OE EXPERTISE. Partner to the world's leading vehicle manufacturers**

## ANTICIPATING THE **FUTURE** WITH **DIESEL3TECH™+** TECHNOLOGY

From **DIESEL3TECH™** to **DIESEL3TECH™+**.

A water separation technology, **DIESEL3TECH™+**, provides a high performance and responds to new **EURO 6C** requirements thanks to an additional water separation layer.

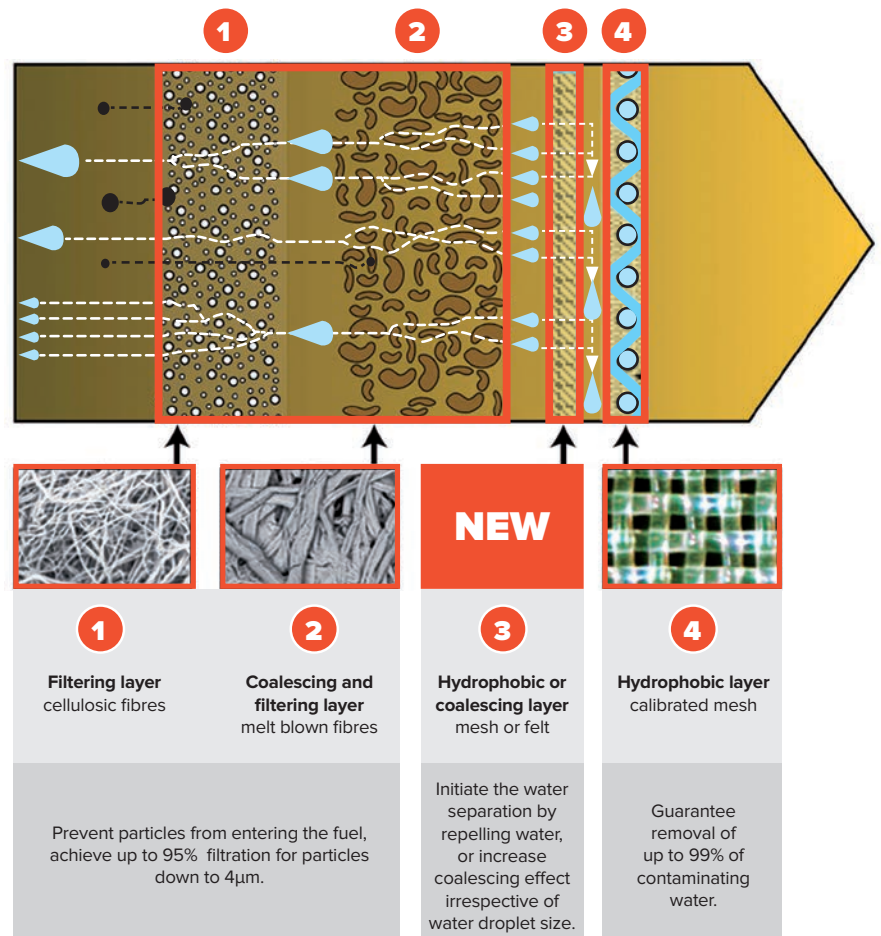
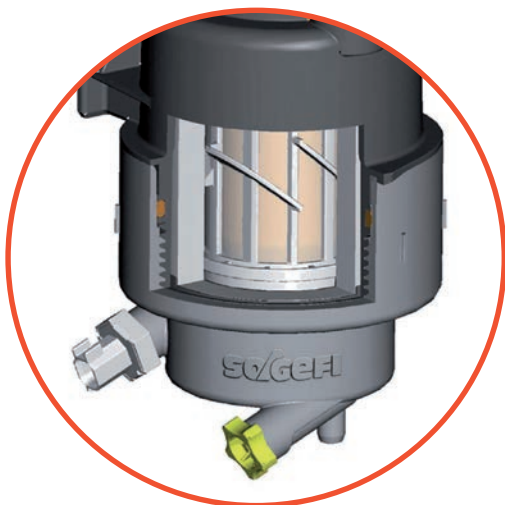

**ANY PART FOR ANY CAR**  
**OVER 200 BRANCHES NATIONWIDE**

Prices correct at time of going to press: July 2017. Prices exclude VAT, VAT will be applied at current rate. Errors & omissions excluded. All purchases and offers contained in this publication are subject to Euro Car Parts terms and conditions as found at [www.eurocarparts.com](http://www.eurocarparts.com).

- Water removal efficiencies up to 99% with water droplet size as low as 10µm (versus 60µm for **DIESEL3TECH™**).
- Compatibility with worldwide applications and most recent evolutions (bio-diesel, latest high pressure fuel injection systems).
- Compliance with requirements of new **EURO 6C** generation engines.

## ANSWERING TODAY'S MARKET NEEDS WITH **DIESEL3TECH™** AND **DIESEL3TECH™+** TECHNOLOGIES

### AN ABSOLUTE NECESSITY

Today's highly sophisticated diesel engines are extremely sensitive to contamination and cold temperatures.

A single particle of dirt can damage the entire fuel system. Droplets of water freezing in the fuel can block the flow in the engine, impeding the vehicle start, or even causing serious damage.

To solve these problems Sogefi introduced Diesel3Tech™ and Diesel3Tech™+ technologies. Both with extreme water separation capabilities, they provide best-in-class protection.



### **DIESEL3TECH™ EURO 5 & EURO 6B**

**C11781ECO**

Citroen C3, C4, Berlingo, DS3, DS4, DS5

Ford C-Max, S-Max, Fiesta, Focus, Mondeo

Peugeot 208, 308, 508, 2008

**C10026A**

Citroen Jumper

FIAT 500, Albea, Croma, Ducato, Idea, Oanda, Doblo

Vauxhall Agila, Astra, Corsa

Peugeot Boxer

Suzuki Swift

**C11957**

Renault Espace, Megane, Talisman



### **DIESEL3TECH™+ FROM EURO 6C (ONWARDS)**

**C12148**

Ford Transit

# FRAM®

## SOGEFI GROUP

## OE SUPPLIER

### SOGEFI: THE CHOICE OF TOP SELLING CAR MAKERS.

Sogefi pioneering technologies are being selected as Original Equipment for **8 of the 10 best selling cars in Europe in 2015**. That is a real evidence of **outstanding quality** and **reliability** of Sogefi products and its aftermarket products available under **FRAM®** brand.

OE on  
**8** of the  
**TOP 10**  
EUROPEAN  
cars



#### RENAULT CLIO

- OIL FILTER:  
CH11442ECO/PH9928/  
PH11440
- AIR FILTER:  
CA9937



#### PEUGEOT 208

- OIL FILTER:  
CH9973AECO/PH5566A  
PH9599
- DIESEL FILTER:  
C11781ECO/P11047
- AIR FILTER:  
CA10418/CA11288



#### FORD FIESTA

- OIL FILTER:  
PH10044
- DIESEL FILTER:  
C11781ECO/P11194



#### FORD FOCUS

- DIESEL FILTER:  
C10778ECO/C11781ECO  
P11194
- OIL FILTER:  
CH9973AECO  
PH9599/PH10044



#### VOLKSWAGEN POLO

- OIL FILTER:  
PH11788



#### NISSAN QASHQAI

- OIL FILTER:  
CH11442ECO  
PH4998/PH11440
- AIR FILTER:  
CA11858



#### OPEL CORSA

- AIR FILTER:  
CA10211/CA10212









#### PEUGEOT 308

- OIL FILTER:  
CH9973AECO/PH9599
- DIESEL FILTER:  
C11781ECO/P11047
- AIR FILTER:  
CA11288

**ANY PART FOR ANY CAR**  
**OVER 200 BRANCHES NATIONWIDE**





		OIL	AIR	FUEL	STANDARD CABIN FILTER	CARBON CABIN FILTER
	<b>Audi A3 2.0 TDI 03-12</b>	<b>£3.50</b> 501 44 0286	<b>£6.60</b> 502 44 0616	<b>£10.80</b> 503 44 0928	<b>£4.80</b> 507 44 0206	<b>£5.15</b> 507 44 0216
	<b>BMW E46 330d 99-05</b>	<b>£4.45</b> 501 11 0246	<b>£13.50</b> 502 11 0266	<b>£21.50</b> 503 11 0186	<b>£8.65</b> 507 11 0156	<b>£9.85</b> 507 11 0166
	<b>Ford Fusion 1.6 02-08</b>	<b>£3.30</b> 501 59 0016	<b>£5.80</b> 502 12 0016	<b>£6.70</b> 503 59 0356	<b>£7.65</b> 507 59 0176	<b>£8.65</b> 507 59 0066
	<b>Mercedes C200 CDI 07&gt;</b>	<b>£3.90</b> 501 22 0176	<b>£10.60</b> 502 22 0706	<b>£10.90</b> 503 22 0316	<b>£5.80</b> 507 22 0266	<b>£12.60</b> 507 22 0496
	<b>Skoda Octavia 1.6 TDI 09-13</b>	<b>£4.55</b> 501 44 0556	<b>£6.60</b> 502 44 0616	<b>£12.10</b> 503 44 0926	<b>£4.80</b> 507 44 0206	<b>£5.15</b> 507 44 0216
	<b>Vauxhall Astra H 1.9 CDTi &gt;10</b>	<b>£5.40</b> 501 72 0136	<b>£7.20</b> 502 72 0226	<b>£12.60</b> 503 88 0066	<b>£5.70</b> 507 72 0116	<b>£11.10</b> 507 72 0026
	<b>VW Golf Plus 2.0 FSI 05-13</b>	<b>£4.70</b> 501 44 0456	<b>£7.20</b> 502 44 0626	<b>£12.70</b> 503 44 0936	<b>£4.80</b> 507 44 0206	<b>£5.15</b> 507 44 0216

## GET TOOLED UP

### Diesel Fuel Filter Lever - VAG

Laser

**£19.99**

LAS6416



### Filter Wrench Adblue Mercedes-Benz 46mm

MasterPro

**£5.99**

538 77 6211



### Oil Filter Drain VAG 2.0 and 2.5 engines

MasterPro

**£12.99**

538 77 4851



# TRIPLE QX OILS

Don't take chances on the quality of the oil that you use. Triple QX gives you the peace of mind you only get from a top quality product.

Oil must be capable of much more than just lubricating and cooling: It must function at elevated temperatures and pressures; it must clean away combustion residue, grit, acids, water and fuel particles; it must protect the engine from corrosion. Modern engine oils are high-tech liquids designed

specifically for use in certain car models, these days they're tailor-made replacement parts, just like any other part for a car.

Oil grades have diversified and emission regulations have become tighter causing vehicle manufacturers to constantly develop new specifications, so it's essential to always have up-to-date and accurate information to hand.

## SynPlus C3 5W-30 for Low Saps Fully Synthetic

Universal, synthetic fuel economy motor oil developed according the most recent technology and based on specially selected base oils with a high natural viscosity index. With the addition of a well-balanced choice of advanced additives to suit the requirements of vehicles with DPF and Three way catalyst

- Low SAPS technology
- Best for modern European vehicles
- Fuel Efficient, reduced wear and low emissions

### Specifications:

- ACEA C3-12, API SN

### Performance:

- MB-229.51/229.52, Dexos 2, BMW LL-04,
- VW 502.00/505.00/505.01



Part Number	Size
521 77 6062	1 Ltr
521 77 6061	5 Ltr
521 77 6065	20 Ltr
521 77 2016	199 Ltr
521 77 1727	Bulk

## SynPlus 5W-30 for VAG Vehicles Fully Synthetic

VW Long-life high performance engine oil is suitable for the latest generation of petrol and diesel engines including VW, Audi, Seat, & Skoda cars and vans. The ultimate in engine protection for all driving conditions.

Low SAPS technology reduces particle build-up in DPFs extending regeneration intervals and catalytic converter life

- Reduction in deposit and sludge tendency extends oil life
- Excellent low temperature fluidity for improved cold start and protection against wear a start-up
- Optimised frictional and anti-wear properties enable long-lasting fuel efficiency and extended engine life

### Specifications:

- ACEA C3-12

### Performance:

- VW 504.00/507.00,
- MB-229.51, BMW LL-04,
- Porsche C30



Part Number	Size
521 77 6092	1 Ltr
521 77 6091	5 Ltr
521 77 6095	20 Ltr
521 77 1656	199 Ltr
521 77 1737	Bulk

**ANY PART FOR ANY CAR  
OVER 200 BRANCHES NATIONWIDE**



## SynPlus 5W-20

### Fully Synthetic

High specification fuel economy oil specially designed for Ford vehicles with Ecoboost petrol engines.

- Lower fuel consumption
- High and very stable viscosity index
- Higher resistance against shearing
- Fast cold start
- Very strong protection against wear, corrosion and foaming

#### Specifications:

- ACEA A1/B1-12, API SN

#### Performance:

- FORD WSS-M2C948-B



Part Number	Size
521 77 6212	1 Ltr
521 77 6211	5 Ltr
521 77 6215	20 Ltr
521 77 6216	199 Ltr

## Supreme HD LS 10W-40 Diesel Low Saps

### Fully Synthetic

This fuel saving lubricant has mainly been developed for heavy diesel engines even under the toughest operation conditions and all the year round. This product is very suitable for EURO 4 and EURO 5 engines in combination with diesel fuel with a low sulphur content. This engine oil is also suitable for application in engines with or without particle filters and exhaust catalysis.

- A powerful activity against wear, resulting in strongly reduced wear of piston-rings and cylinder-liners
- Low SAPS formulation protects emission control equipment
- Excellent high and low temperature performance
- Excellent fuel efficiency and deposit control
- Very high standard of engine cleanliness
- Long lasting performance and engine protection

#### Specifications:

- ACEA E6-12, E7-12, API CI-4

#### Performance:

- MB-228.51/226.9, MAN M 3477/M
- 3271-1, Volvo VDS-3, Mack EO-N,
- Renault VI RLD-2, DAF Long Drain,
- Renault VI RXD, MTU Type 3.1,
- Deutz DQC III-10 LA, JASO DH-2,
- Cummins CES 20076/20077



Part Number	Size
521 77 6122	1 Ltr
521 77 6121	5 Ltr
521 77 6125	20 Ltr
521 77 2096	199 Ltr
521 77 1837	Bulk

## SynPlus 5W-40 for PD Engines

### Fully Synthetic

High performance long life petrol and diesel engine oil specially designed for use in Volkswagen, Audi, Seat and Skoda diesel cars and light vans fitted with a Pompe Duse (PD) engine. The ultimate in engine protection for all driving conditions.

- Low SAPS technology
- Fuel Efficient, reduced wear and low emissions
- Engine protection at extreme temperature conditions

#### Specifications:

- ACEA C3-12, API SN/CF

#### Performance:

- VW 502.00/505.00/505.01
- MB 229.51/229.31/226.5,
- BMW LL-04, Ford M2C917-A,
- Porsche A40,
- Renault RN0700/RN0710,
- Dexos 2, Fiat 9.55535-S2



Part Number	Size
521 77 6082	1 Ltr
521 77 6081	5 Ltr
521 77 6085	20 Ltr
521 77 2036	199 Ltr
521 77 2037	Bulk

**BUY NOW**

**PAY LATER**

# BATTERIES

**CAR • COMMERCIAL • BIKE • LEISURE**



**ANY PART FOR ANY CAR  
OVER 200 BRANCHES NATIONWIDE**



BUY ANY  
**10**  
BATTERIES

**GET A FREE BATTERY STAND  
WITH HEADER BOARD OR  
BATTERY WOBBLE BOARD\***



Battery Stand: 997 77 6660  
Duracell Header: 999 77 0841



Battery Stand: 997 77 6660  
Bosch Header: 997 77 4031



Battery Stand: 997 77 6660  
Exide Header: 412 99 1001



Battery Stand: 997 77 6660  
Lion Header: 997 77 4151

Bosch Wobble Board: 997 77 4221  
Exide Wobble Board: 997 77 4211  
Lion Wobble Board: 997 77 4131  
Wobble Board Base: 997 77 4121  
(to be given with each wobble board)



DHC Memory Saver With  
Battery Back Up  
447 44 041P

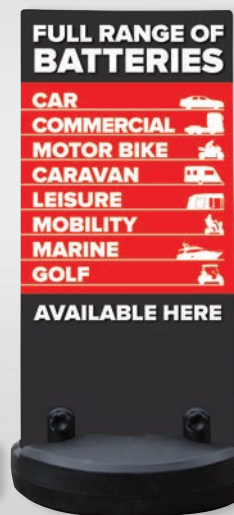

Above: Generic reverse  
of all Wobble Boards

BUY ANY  
**15**  
BATTERIES

**GET A FREE DHC MEMORY SAVER  
WITH BATTERY BACK UP AND  
STAND OR WOBBLE BOARD**

Buy Now Pay January 2018 offer available on minimum purchase of 10 batteries in any combination of brand type and rating. Available on batteries from Exide, Lion, Duracell and Bosch. All credit is subject to status and may be refused. This offer is valid until 31st October 2017.

Euro Car Parts reserve the right to withdraw credit at any time. Maximum credit allowances apply; contact your branch for details. All products purchased on Buy Now Pay Later schemes are non-returnable. Offers available to trade customers only. Automotive, Commercial, Bike and Leisure batteries only. \*Only one stand/wobble board per customer \*\*While stocks last.



# Win a fantastic Palmer Sport Track Day

## 2017 palmer SPORT

- We're giving away 30 exclusive Palmer Sport track driving experience days for purchases of batteries in July, August and September.
- One free entry per battery will be entered into a prize draw.
- Each month of July, August and September we will be drawing out 10 lucky winners.



PalmerSport is a corporate hospitality driving event created by Jonathan Palmer. With our morning-only Formula programme at Bedford Autodrome, guests can enjoy superb hospitality and driving time in some of our most thrilling cars, but without the need to take a full day out of the office. They will be encouraged to push themselves – and our machinery – harder than they may have imagined possible, and all in outstanding safety. It's the experience of a lifetime...

### FORMULA PROGRAMME LINE UP

Every guest drives each of these cars in one sublime morning:



Formula 3000



Palmer JP-LM



Land Rover Defender



Caterham Pursuit



Sodi Go Karts

Located right in the centre of England – just 50 miles north of London.



#### EVENT ITINERARY

- 07:45** Hospitality suite opens
- 08:00** Registration and breakfast
- 08:30** Event briefing  
The lowdown on the morning's activities and how best to do them.
- 09:00** Driving commences  
Go, Go, Go! Drivers meet their instructors and take to the track in the first of 5 vehicles
- 12:00** Lunch and prizegiving  
A two course lunch, waitress served with trophies presented to the best drivers.
- 13:00** Guests depart

- Five activity programme with scoring and awards
- Centrally located at the purpose built Bedford Autodrome
- First class instructors who encourage the timid and challenge the enthusiast
- Modern trackside and hospitality suites with superb catering
- Onboard footage of you driving the F3000 single seater
- Available for 1 to 36 guests (up to 48 guests can be accommodated on selected dates)
- F1-style live timing, full site WiFi and mobile phone charging in every suite



For more information, please visit:

[www.palmersport.com/palmersport-formula.aspx](http://www.palmersport.com/palmersport-formula.aspx)

**ANY PART FOR ANY CAR  
OVER 200 BRANCHES NATIONWIDE**



# REPLACING BOSCH DIESEL INJECTORS?

## WHY YOU SHOULD CHOOSE BOSCH BX EVERYTIME

### ALL REMANUFACTURED INJECTORS ARE THE SAME AREN'T THEY??

You need a new set of Injectors...Ouch! You could be looking at anything from £800.00 to £1200.00 if you buy them new, and certainly more if purchased direct from the vehicle manufacturer. Looks like your Credit card may be getting an unwelcome workout.

In many cases the outlay is often worth more than the actual vehicle, so it's no surprise the most popular option is to purchase Remanufactured Injectors. Spending £450.00 to £500.00 on a set, although not palatable....is not quite as bitter a pill to swallow then what one would pay for brand new injectors.

But why do the 'same' remanufactured injectors fluctuate so greatly in cost? Why one Bosch Remanufactured injector can cost circa £120.00 - £150.00 per injector, and another £85.00 - £90.00, for what is effectively the same part number?? The answer is quite simple.

### NOT ALL BOSCH REMANUFACTURED INJECTORS ARE THE SAME.



**BOSCH**



### BOSCH BX –

THE DIESEL EXCHANGE PROGRAM  
WITH AN 'AS NEW' GUARANTEE.



### REMANUFACTURED INJECTORS TYPICALLY FALL INTO 2 CATEGORIES.

1. 3rd party Injectors
2. A Bosch BX Factory Remanufactured Injector.

### EURO CAR PARTS AND BOSCH BX

Euro Car Parts are committed to offering our customers the best in class Diesel Injectors in the market. We realize that a vehicle running with a Bosch Diesel System will be best served and serviced using Bosch BX injectors for replacement. Having invested heavily in the Bosch BX program, you can rest assured that Euro Car Parts comfortably cover the range for the UK Car Parc.

**IF YOUR CUSTOMER'S VEHICLE HAS A BOSCH  
DIESEL SYSTEM, CHOOSE BOSCH BX FIRST TIME....  
EVERY TIME.**

**Alfa Romeo 147. 1.9 JTD**

**£145.00**

432 77 0090

**Chrysler Voyager IV, 2.5 CRD**

**£155.00**

432 83 0010

**Ford Focus 1.6 TDCi**

**£135.00**

432 59 0240

**Mercedes Sprinter 308 CDI, 2.2**

**£140.00**

432 22 0490

**Renault Megane 1.9 dCi**

**£130.00**

432 74 5310

**Vauxhall Astra MK V, 1.3 CDTi**

**£125.00**

432 72 0340





official partner

# Every car deserves Brembo

Brembo offers every vehicle the quality and performance of a global leader in braking systems. The high level of technology and the company's vast experience producing systems for major car manufacturers, combined with complete control of the production process, allows Brembo to provide the widest and most reliable range of spare parts, covering more than 96% of the vehicles on the road today.

## Brembo Brake Discs

### Jeep Cherokee 01-08

Front

**£26.99**

104 52 011A

### Kia Sorento 02>

Rear

**£41.99**

104 90 015A

### Land Rover Range Rover 02-12

Rear

**£31.99**

104 67 015A

### Mercedes-Benz Sprinter 95-06

Rear

**£17.99**

104 22 063A

### Mitsubishi Shogun 99-08

Rear

**£23.99**

104 69 001A

### Mazda 6 02-08

Front

**£31.99**

104 68 005A

### Nissan Micra 90-03

Front

**£11.99**

104 70 001A

### Nissan Note 05-12

Rear with wheel bearing & ABS sensor ring

**£42.99**

104 74 552A

### Vauxhall Combo 01-12

Rear

**£14.99**

104 72 040A

## Brembo Brake Pads

### Chevrolet Lacetti 03>

Front

**£16.99**

101 86 001A

### Citroen Xantia 93-03

Rear

**£9.99**

101 54 533A

### Fiat Punto 93-12

Front

**£15.99**

101 58 028A

### Hyundai i10 07-13

Front

**£24.99**

101 90 012A

### Land Rover Discovery 98-04

Rear

**£19.99**

101 67 006A

### Lexus IS 99-05

Front

**£19.99**

101 82 033A

### MINI One 10>

Rear

**£21.99**

101 12 010A

### Vauxhall Astra >98

Front

**£11.99**

101 72 004A

### Volvo S60 00-10

Rear

**£16.99**

101 66 027A

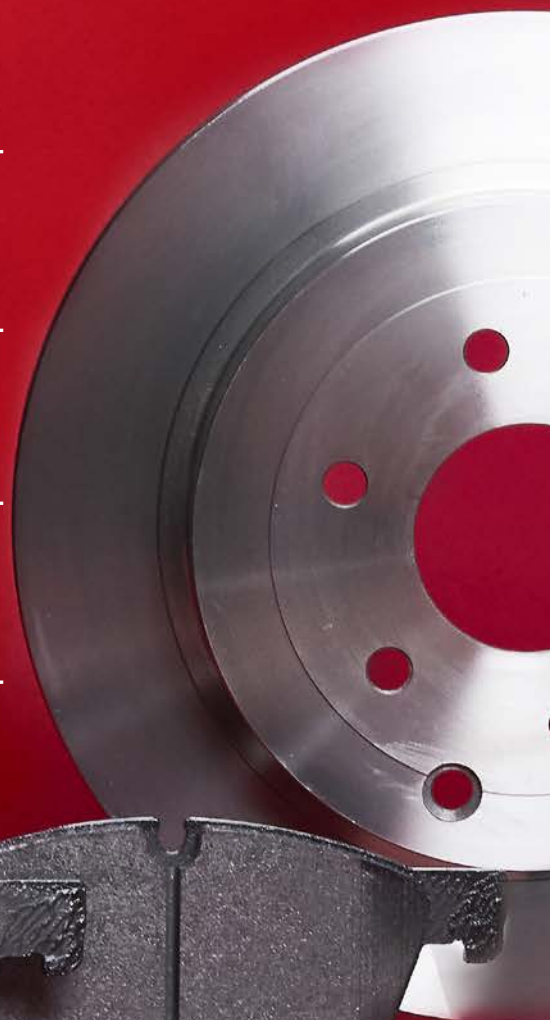

**ANY PART FOR ANY CAR  
OVER 200 BRANCHES NATIONWIDE**





# Think you're a motorsport expert? **PROVE IT!**

REGISTER | PLAY | WIN



## The Formula Brembo Contest 2017

FOR THE CHANCE TO WIN TO **WIN TICKETS TO**

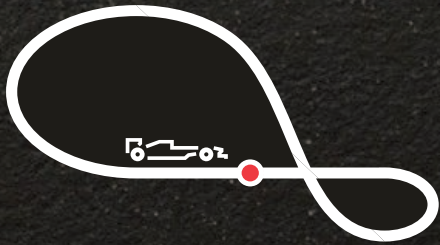

GREAT BRITAIN | **SILVERSTONE**

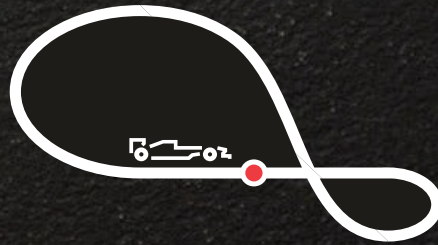

ITALY | **MONZA**

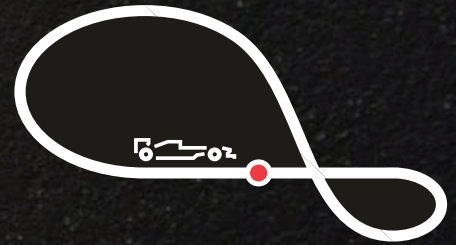

UNITED ARAB EMIRATES | **ABU DHABI**

**PREDICT THE STARTING GRID AND WIN PRIZES**

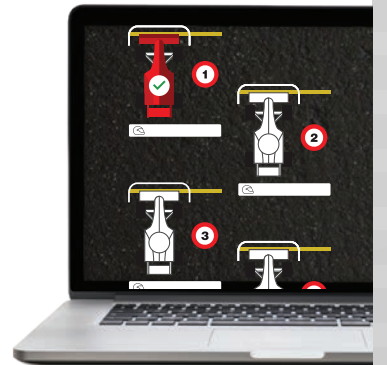

**FOR TERMS AND CONDITIONS VISIT [WWW.FORMULABREMBO.CO.UK](http://WWW.FORMULABREMBO.CO.UK)**



To register you will need an invoice from Euro car Parts that is associated with the purchase of a Brembo product issued after 15/03/2017. Full terms and conditions can be found at [www.formulabrembo.co.uk](http://www.formulabrembo.co.uk)



# eicher

- 100% R90 complaint
- 2-year / 24,000 miles guarantee
- Over 97% UK vehicle park coverage
- Exclusive to Euro Car Parts
- In the top 5 of braking brands in UK

## Eicher Brake Pads

### Audi A4 00-09

Rear

**£7.99**

101 44 0199

### Nissan Micra 92-07

Front

**£10.99**

101 70 0019

### Ford Focus 98-07

Front

**£11.99**

101 59 0039

### Peugeot 206 98>

Front

**£9.99**

101 73 5179

### Honda Civic 94-06

Front

**£11.99**

101 60 0019

### Saab 9-3 02-15

Front

**£12.99**

101 88 0209

## Eicher Brake Discs

### BMW 3 Series 90-05

Front

**£13.99**

104 11 0029

### Vauxhall Combo 01-12

Front

**£11.99**

104 72 0119

### Ford Mondeo 00-07

Front

**£14.99**

104 59 0099

### Volkswagen Golf 97-06

Front

**£14.99**

104 44 0729

### Vauxhall Astra 98-05

Front

**£12.99**

104 72 0039

### Volkswagen Passat 96-01

Front

**£14.99**

104 44 0189

### Mercedes-Benz C-Class 00-11

Front

**£15.99**

104 22 0829



# PAGID

- UK's largest brand – 99.7% vehicle park coverage
- Exclusive to Euro Car Parts
- 28 different product groups
- Largest range of geomet coated discs

## Pagid Brake Pads

### Audi A4 00-08

Rear

**£12.99**

101 44 0198

### Ford Transit 06-14

Rear

**£19.99**

101 59 1288

### BMW 3 Series >05

Front

**£15.99**

101 11 0138

### Honda Civic 94-06

Front

**£12.99**

101 60 0018

### Mercedes-Benz C-Class 00-11

Rear

**£11.99**

101 22 0428

### Renault Clio 90-99

Front

**£9.99**

101 74 5198

## Pagid Brake Discs

### Ford Fiesta 95-10

Front

**£14.99**

104 59 0068

### Ford Mondeo 00-07

Front

**£19.99**

104 59 0098

### Vauxhall Astra 98-10

Front

**£15.99**

104 72 0058

### Volkswagen Golf 97-06

Front

**£19.99**

104 44 0728

### Audi A4 94-08

Front

**£20.99**

104 44 0188

### Renault Scenic 03>

Rear

**£34.99**

104 74 5828

### Mercedes-Benz C-Class 00-11

Front

**£21.99**

104 22 0828



**ANY PART FOR ANY CAR  
OVER 200 BRANCHES NATIONWIDE**



## ABS Sensor

### Mercedes E-Class 02>

Front  
**£48.99**

417 22 1188

### Peugeot 307 00>

Rear  
**£22.99**

417 73 5278

### Volkswagen Golf 03-13

Rear  
**£33.99**

417 44 0698

### Citroen C6 05>

Front  
**£26.99**

417 54 5508



## Wheel Cylinder

### Chevrolet Matiz 05>

**£12.99**

134 86 0208

### Ford Transit 91-14

**£9.99**

134 59 0088

### Peugeot Partner 96-15

**£7.99**

134 73 5288

### Renault Clio 98>

**£11.99**

134 74 5488



## Brake Shoes

### Ford Transit 00-11

**£33.99**

102 59 0258

### Mitsubishi Colt 04-08

**£28.99**

102 69 0158

### Peugeot 206 98>

**£16.99**

102 73 5258

### Vauxhall Vectra 91-05

**£18.99**

102 72 0038



## Calipers\*

### VW Golf 99>

Rear LH  
**£46.99**

133 44 2190

Rear RH  
**£46.99**

133 44 2200

### Toyota Corolla 02>

Front LH  
**£54.99**

133 82 144J

Front RH  
**£54.99**

133 82 145J

### Renault Trafic 03>

Rear LH  
**£64.99**

133 72 0831

Rear RH  
**£64.99**

133 72 0841



\*Excludes surcharge price

# ARCTIC COMMANDER



Mastercool introduces its new ARCTIC COMMANDER line of machines. Equipped with the latest technology, all models come standard with an 8" command centre. The graphic user interface (GUI) will enable navigation through all functions and features with the greatest of ease. There is no longer a need to read any external instructions or paper manuals, simply sit back, watch and learn how to use your machines. All machines are also equipped with Wi-Fi capabilities; allowing for real time, interactive communication and troubleshooting.

**It's about time somebody introduced machines for the 21st century!**

## Take a look under the hood...

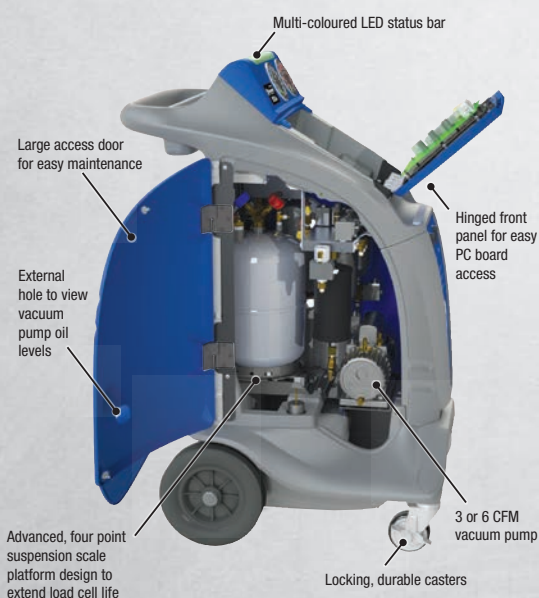

### ALARMS

**AUTO FILTER ALARM** Warns that a filter change is required  
**FULL TANK ALARM** Notifies when tank is full  
**LOW REFRIGERANT ALARM** Notifies when refrigerant is low



### AUTOMATIC OIL DISCHARGE

Oil is automatically discharged during the recovery process. If oil is present, it will drain into a graduated container clearly displaying the amount of oil that was removed



### AUTOMATIC VACUUM LEAK TEST

Checks for leaks during the vacuum phase. The operation will be interrupted and an alarm will sound if leaks are found



### COMPACT DESIGN

The machine's compact design makes it easy to manoeuvre and requires minimal shop space



### TANK HEATER

Provides quick charging at high or low temperatures



### COOLING FAN

Dedicated PC board cooling fan keeps the PC board consistently cool

**ANY PART FOR ANY CAR  
OVER 200 BRANCHES NATIONWIDE**



# Fully responsive “touch screen” command centre...



## Home Screen

allows for quick touch selection of options

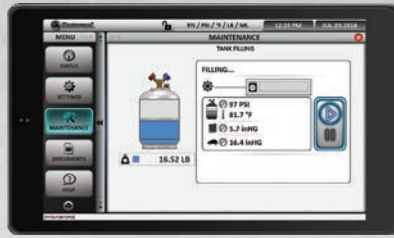

## Tank Fill Screen

allows for visual, real time progress of tank filling process



## Vacuum/Leak Test Screen

fully customisable options allows the user to personalise the times of vacuum and leak testing



## Status Screen

for quick reference of resources



## Settings Screen

allows the user to select a default language, units, temperature, volume and weight measurement



## Maintenance Screen

offered only to authorised service technicians allowing for quick and easy diagnosis



## WI-FI

Wi-Fi capability allows for real time, interactive communication and troubleshooting



## ON-BOARD UNITS CONVERSION CALCULATOR

Easily convert between different units of measure



## ON-BOARD INSTRUCTION MANUAL

Watch and learn how to use the machine



## SELF-DIAGNOSTIC CHECK

With a touch of a button, check all of the integral functions of the machine

# MASTERCool COMMANDER 2000-E

251 77 0170

Fully Automatic R134a Machine



## HOSE FLUSHING

Eliminates the chance of excess (non-insulating) oils being injected into the A/C system. Utilised for service of hybrid vehicles.



## THERMAL PRINTER

For a comprehensive, printed report.



## STATUS LIGHT

Multi-coloured LED status bar offers visual confirmation of machine progress.

## FEATURES:

- 8" Colour Command Centre with Touch Screen
- Automatic and Manual Procedures
- Refrigerant Database
- Automatic Vacuum Leak Test: Programmable
- Auto Oil Discharge
- Auto and Manual Air Purge
- Auto Filter and Full Tank Alarm
- Low Refrigerant Alarm
- Auto Oil Injection
- Cylinder Heater
- 6 CFM Vacuum Pump
- On-board Instruction Manual
- Multiple Languages
- On-board Unit Conversion Calculator
- New Cabinet Design for Increased Air Flow
- Large Analogue Gauges
- Hard Wired Power Cord
- Hose Coupler Storage
- Solid Durable Wheels with Locking Casters
- Multi-coloured LED Status Bar
- Self-Diagnostic Check
- Wi-Fi Capable

**£2,299.99**





# MASTERCool COMMANDER 3000-E

251 77 0190

Fully Automatic R134a & Hybrid Machine with Printer



### HOSE FLUSHING

Eliminates the chance of excess (non-insulating) oils being injected into the A/C system. Utilized for service of hybrid vehicles.



### THREE BOTTLES

Two sealed bellows design bottles for selection of oils or dyes. One used oil bottle.



### THERMAL PRINTER

For a comprehensive, printed report.



### STATUS LIGHT

Multi-coloured LED status bar offers visual confirmation of machine progress.

Custom Design Dust Cover Included



## FEATURES:

- 8" Colour Command Centre with Touch Screen
- Automatic and Manual Procedures
- Refrigerant Database
- Automatic Vacuum Leak Test: Programmable
- Auto Oil Discharge
- Auto and Manual Air Purge
- Auto Filter and Full Tank Alarm
- Low Refrigerant Alarm
- Auto Oil Injection (for non-hybrid vehicles only)
- Thermal Printer
- Hose Flushing
- Vehicle A/C System Flushing
- Cylinder Heater
- 6 CFM Vacuum Pump
- On-board Instruction Manual
- Multiple Languages
- On-board Unit Conversion Calculator
- New Cabinet Design for Increased Air Flow
- Large Analogue Gauges
- Hard Wired Power Cord
- Hose Coupler Storage
- Solid Durable Wheels with Locking Casters
- Multi-coloured LED Status Bar
- Self-Diagnostic Check
- Wi-Fi Capable

**£2,509.99**

# MASTERCool COMMANDER 4000-E-X

251 77 0200

Fully Automatic R1234yf & Hybrid Machine with Printer



### HOSE FLUSHING

Eliminates the chance of excess (non-insulating) oils being injected into the A/C system. Utilized for service of hybrid vehicles.



### THREE BOTTLES

Two sealed bellows design bottles for selection of oils or dyes. One used oil bottle.



### THERMAL PRINTER

For a comprehensive, printed report.



### STATUS LIGHT

Multi-coloured LED status bar offers visual confirmation of machine progress.

Custom Design Dust Cover Included



## FEATURES:

- 8" Colour Command Centre with Touch Screen
- Automatic and Manual Procedures
- Refrigerant Database
- Automatic Vacuum Leak Test: Programmable
- Auto Oil Discharge
- Auto and Manual Air Purge
- Auto Filter and Full Tank Alarm
- Low Refrigerant Alarm
- Auto Oil Injection
- Thermal Printer
- Hose Flushing
- Vehicle A/C System Flushing
- Cylinder Heater
- 6 CFM Vacuum Pump
- On-board Instruction Manual
- Multiple Languages
- On-board Unit Conversion Calculator
- New Cabinet Design for Increased Air Flow
- Large Analogue Gauges
- Hard Wired Power Cord
- Hose Coupler Storage
- Solid Durable Wheels with Locking Casters
- Multi-coloured LED Status Bar
- Self-Diagnostic Check
- Wi-Fi Capable

**£2,619.99**

**ANY PART FOR ANY CAR  
OVER 200 BRANCHES NATIONWIDE**



# ATOM MACHINE ULTRASONIC NEBULISER

**Comes with 48 bottles of Pure Zone sanitising treatment.**

The **Atom Machine** is a powerful electronic ultrasonic nebuliser designed to atomise the specially formulated **Pure Zone** sanitising liquid, the resulting vapours (less than 5 microns) are distributed by the vehicles **A/C System** to sanitise and deodorise the interior of the vehicle and the **A/C System**.

**£89.99**  
244 77 0250



**SAVE 10%**



**Atom Purifying Liquid**

250ml x 24 Bottles

**£49.99**

<b>Lemon</b>	244 77 0410
<b>Pure</b>	244 77 0420
<b>Green</b>	244 77 0430
<b>Mint</b>	244 77 0440

# R134a ELECTRONIC LEAK DETECTOR WITH BUILT IN LED LIGHT & UV GLASSES

**£161.99**  
261 77 0010

This revolutionary design allows the user to perform Electronic and UV Leak Detection all with one tool. Offering six levels of sensitivity (15 levels of detection) with a tri-coloured LED indicator. This allows it to pin-point leaks as small as 3g (110 oz) per year. The ultra bright UV light is built into the end of the probe allowing easy access into tight areas. Incorporating both electronic and UV technology into one unit ensures that even the toughest leaks can be found.



**SAVE 10%**



## SPECIFIC FEATURES:

- Ultra bright UV/blue LED light
- UV safety glasses
- 6 levels of sensitivity (15 levels of detection)
- Tri-coloured Visual Leak
- Level Indicator
- Mute function
- Detects leaks as small as 3g (110 oz) per year
- Detects all refrigerants, CFC's, HCFC's, HFC's
- Includes a custom moulded carrying case

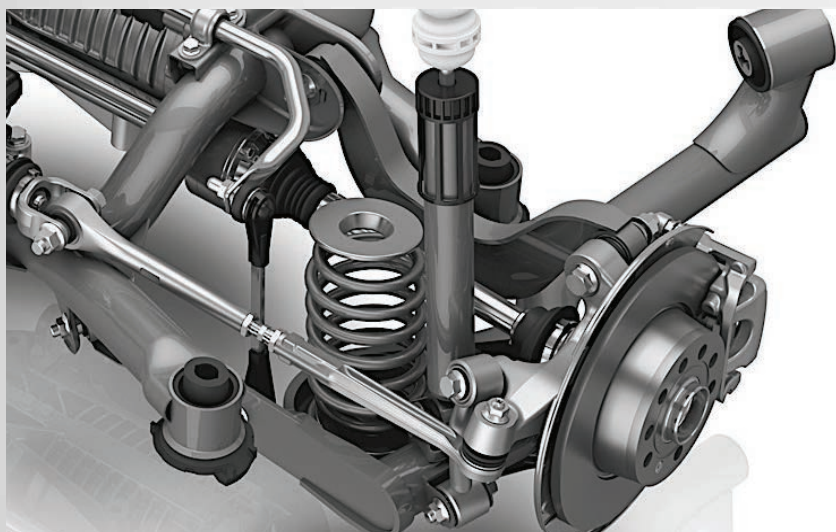

- Fit and Forget safety critical parts you can trust
- Identical product supplied to both vehicle manufactures and the aftermarket
- Access to technical support and documentation
- IMI accredited training courses available from ZF in Crick

TRW is at the forefront of the design, manufacture and development of steering & suspension systems supplying over 40 vehicle manufacturers worldwide. With close links to OE system design & development, independently benchmarked against competitor and OE parts, you can have peace of mind that the experts trust our products as much as we do.

## BALL JOINTS



### Lexus IS 99-05

Lower LH / Lower RH

**£20.95**

617 82 1026 / 617 82 1036

### Mercedes C-Class (202) 93-01, CLK (208) 97-02, E-Class (210) 95-03

Lower LH / RH

**£15.95**

617 22 0106

### Renault Laguna 01> & Trafic 01> & Vauxhall Vivaro 01>

Lower LH / RH

**£16.95**

617 74 5186

### Volvo V70 MK2 00>

Lower LH / RH

**£15.95**

617 66 0126

## STABILISER LINKS



### Citroen C4 04>, Peugeot 307 00>

Front LH / RH

**£12.95**

600 73 5326

### Vauxhall Astra 98>, Zafira 99>

Front LH / RH (Plastic Type)

**£11.95**

632 72 0076

### VW Sharan 95>, Ford Galaxy 95-06, Seat Alhambra 96>

Front LH / RH

**£11.95**

605 44 0386

### Citroen C-Elysee 12>, C3 Picasso 09> / Peugeot 207 06>, 208 12>

Front LH / Front RH

**£9.95**

632 73 0036 / 632 73 0046

## SUSPENSION ARMS



### BMW 1-Series 10>, 3-Series 11>

Front Lower LH / RH

**£44.95**

615 11 1806 / 615 11 1816

### Ford Focus 03-12, C-MAX 07-10 / Volvo C30 06-12, C70 06-13, S40 04-12

Front Lower LH / RH (W/out Xenon headlights)

**£58.95**

615 59 0956 / 615 59 0966

### Smart Fortwo 07>

Front Axle Lower LH/RH

**£39.95**

615 91 0076

### VW Passat 05>

Front Axle Lower LH/RH

**£74.95**

615 44 0976

**ANY PART FOR ANY CAR**  
**OVER 200 BRANCHES NATIONWIDE**





**Starline**

Attractive solution

# STEERING PARTS

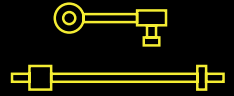

Quality underpins each, and every component; Starline steering and suspension products are precision manufactured to high quality standards, using the latest CNC machines and the very best raw materials. A quality controlled metallurgy process ensures material quality is maintained and state-of-the-art anti-corrosion solutions protect and prolong the life of the products. Testing shows consistent performance up to 900 hours of continuous salt spray testing and the ability to withstand extreme temperatures of +120°C and -40°C. R & D processes are employed to thoroughly prove each product through both static and dynamic testing.

All this results in high quality products, supported with a massive 3-year warranty. They look great and perform even better!

The Starline Steering & Suspension range will build to a huge 3,335 part numbers and will include:

- Suspension Arms, or Control Arms, including Aluminium forged, Steel forged and pressed steel arms
- Ball Joints
- Bushes
- Stabiliser Links
- Inner and Outer Tie Rods
- Suspension Kits
- Gearbox and Engine Mounts



With a wide product range and fast introduction of new items Starline is a perfect fit for the UK.

## BALL JOINTS



**Citroen C4 09>, DS4 11-15, DS5 11-15, Peugeot 308 07>**

Lower LH/RH  
**£8.45**  
617 73 5139

**Ford Galaxy 06-15, Mondeo 07>, SMAX 06-14 / Volvo S80 06>, V70 07>**

Lower LH/RH  
**£12.45**  
617 59 0649

**Ford Transit 00-06, Connect 02>**

Lower LH/RH  
**£8.95**  
617 59 0489

**Nissan Murano 03-08, Qashqai 07>, X-Trail 07-13**

Lower LH/RH  
**£9.45**  
617 70 1159

## STABILISER LINKS

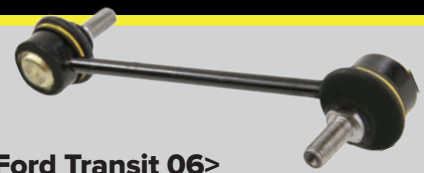

**BMW 5-SERIES (E60) 03>**

Front LH/RH  
**£10.45**  
632 11 0039 / 632110049

**Honda Civic MK7 99-06**

Rear LH/RH  
**£10.45**  
632 60 0749 / 632 60 0759

**Ford Transit 06>**

Rear LH/RH  
**£14.45**  
632 59 0419

**Nissan Murano 07-14, Qashqai 06-13, X-Trail 07> / Renault Koleos 08>**

Front LH/RH  
**£10.45**  
632 70 0699 / 632 70 0709

## SUSPENSION ARMS



**Citroen C3 09>, C4 14>, DS3 09-15**

Front Axle Lower LH/RH  
**£29.95**  
615 54 5439 / 615 54 5449

**Honda Civic (ES) 00-06, Civic (EM2) 01-05**

Front Lower LH/RH  
**£42.95**  
615 60 0219 / 615 60 0229

**Ford Fiesta 08> / Mazda 2 07-15**

Front Axle Lower LH/RH  
**£34.95**  
615 59 3069 / 615 59 3079

**VW Passat 08-14, Tiguan 07>**

Front Lower LH/RH  
**£49.95**  
615 44 2199 / 615 44 2209

## TIE ROD ENDS

**BMW 5 (E60/E61), 6 (E63/E64), 7 (E65/E66) 01>**

LH/RH  
**£12.45**  
606 11 0279

**Ford Galaxy 06-15, Mondeo 07>, SMAX 06-14 / Volvo S60 06>, V70 07>**

LH/RH  
**£6.45**  
606 59 0899 / 606 59 0909

**Mercedes C-Class (203) 00-11, CLK (209) 02-09**

LH/RH  
**£8.45**  
606 22 0249 / 606 22 0259

**Nissan Micra 02> / Renault Clio 05>, Modus 04>**

LH/RH  
**£9.45**  
606 74 5529 / 606 74 5539

# LEMFÖRDER - OEM QUALITY

## ■ SUSPENSION ARMS

**Mercedes C-Class (203) 00-11,  
CLK (209) 02-09**

Front Axle Lower LH (Sheet Steel)

**£59.95**

610 22 0665

**Mercedes C-Class (203) 00-11,  
CLK (209) 02-09**

Front Axle Lower RH (Sheet Steel)

**£59.95**

610 22 0675

**Ford Galaxy 06-15, Mondeo 07>,  
Smax 06-14 / Volvo S60 06>, V70 07>**

Front Axle Lower LH / RH

**£72.95**

615 59 0885 / 615 59 0895

**BMW 1-Series (E81) 04>,  
3-Series (E90) 05-11**

Rear Axle Upper Centre LH/RH

**£49.95**

616 11 0485

**VW Polo 01> / Seat Ibiza 02> /  
Skoda Fabia 99-08**

Front Axle Lower LH/RH

**£24.95**

616 44 0785

## ■ TIE ROD ENDS

**BMW 1-Series (E81) 04-12 /  
3-Series (E90) 05-11**

LH/RH

**£27.95**

606 11 0315 / 606 11 0325

**Citroen Berlingo 08>, C4 04-11, Xsara  
97-10 / Peugeot Partner 96>, 307 02>**

LH/RH

**£5.95**

606 54 5025

**Renault Clio, Megane, Scenic,  
Kangoo 98>**

LH/RH

**£11.95**

606 74 5275 / 606 74 5285

**Vauxhall Corsa 93-00,  
Combo 94-01, Tigra 94-01**

LH/RH

**£8.95**

606 72 0065

## ■ STABILISER LINKS

**Alfa Romeo Giulietta 10>, Mito 08>**

Front LH/RH

**£13.45**

632 51 0835

**Vauxhall Astra 98>, Insignia 08>,  
Zafira 98>, Ampera 12>**

Front LH/RH (Plastic Type)

**£13.95**

632 72 0205

**Mercedes Sprinter (906) 06> /  
VW Crafter 06>**

Front LH/RH

**£16.95**

632 22 6395 / 632 22 6405

**Vauxhall Corsa Mk2 00>,  
Vectra 95-02 / Saab 9-5 97>**

Front LH/RH

**£12.95**

632 72 0035

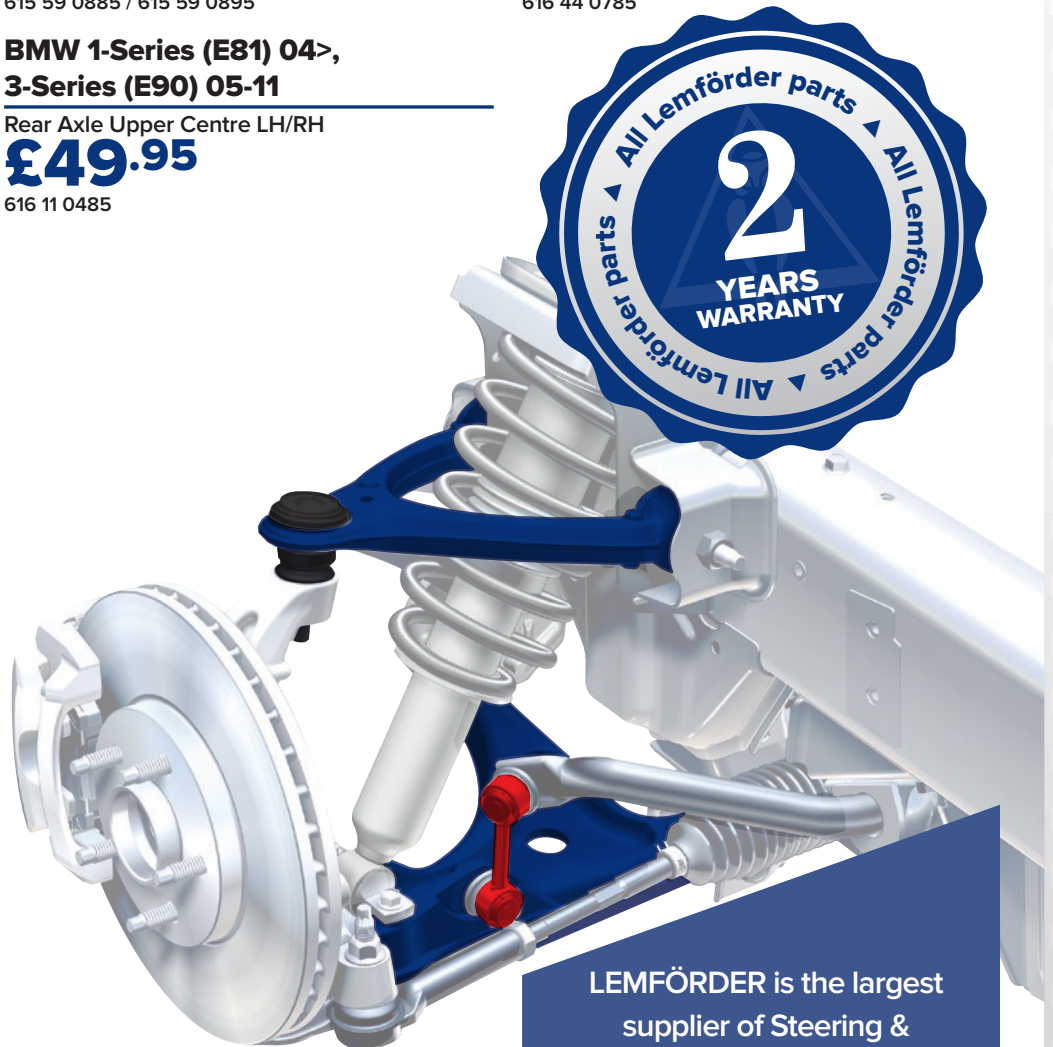

LEMFÖRDER is the largest supplier of Steering & Suspension Original Equipment parts for the European market, supplying approximately 40% of OE Steering & Suspension contracts worldwide. LEMFÖRDER supplies the same Original Equipment quality to both Original Equipment Manufacturers and Aftermarket.

**ANY PART FOR ANY CAR  
OVER 200 BRANCHES NATIONWIDE**



# EURO ACADEMY

ANY  
CUSTOMER

ANY  
DIAGNOSTIC DEVICE

ANY  
VEHICLE MANUFACTURER

Ever had a problem you can't fix? The increasing complexity of new systems and engine options now including petrol, diesel, electric or hybrid, computers controlling almost every aspect of their operation- from suspension, braking, fuel and air flow, to emissions, traction and parking assistance.

How are the independent workshops going to be able to compete? With no information available to help the only option is to call in a specialist or turn the job away to a main dealer.



## EURO ACADEMY MEMBERSHIP NOW OFFERS YOU ACCESS TO SUPERB TECHNICAL INFORMATION AND ASSISTANCE IN 3 DIFFERENT WAYS:



TECHNICAL HELPLINE



ONLINE FAULT LIBRARY



TRAINING FACILITY

Euro Academy Technical helpline is like having a master technician standing next to you. Unlike some of our competitors

- **NO LIMIT** to the amount of time you can spend on a call
- **NO LIMIT** to the number of times you can call us
- **EXPERIENCED** based fault diagnostics from 1000's of customers Our team of master technicians have years of practical experience along with access to the latest technical information on any vehicle, regardless of the manufacturer.

So whether you're looking for repair manuals, circuit diagrams, parts catalogues or component locations for any vehicle in your workshop, simply pick up the phone and let us help. One simple call to our technical helpline could save you hours of searching for an elusive component failure.

## YOUR MEMBERSHIP

Becoming a Euro Academy member is an investment in your business, and one which will increase revenue and profits while saving time and money. Memberships are available by annual subscription paid monthly, and start from as little as £79.00 for level 1 subscribers.

FROM  
ONLY **£79.99**

**CONTACT YOUR LOCAL BRANCH FOR MORE DETAILS**

# PARALLEL VS TAPERED WIRE COIL SPRINGS

**SACHS** offer the world's largest range of automotive coil springs, covering more than 10,000 standard and heavy duty applications. To provide a choice for installers, the **SACHS** coil spring range features a selection of tapered wire alternatives to sit alongside their existing parallel wire designs.

While the vast majority of **OE coil springs** are made from parallel spring wire, that maintains a constant thickness throughout the length of the spring, a small number of **OE** producers employ tapered wire springs on a limited and declining

number of applications in order to achieve a slight weight saving.

**SACHS** parallel wire alternatives are designed to match the spring rate and vehicle-handling characteristics of the original tapered wire spring, with the additional benefit of lower stress levels at critical points within the spring, making premature failure less likely. Some installers prefer to fit identical-looking replacements however, and **SACHS** are happy to offer a choice: parallel wire or tapered wire for the **OE** look.



**SACHS Springs** – The complete range of automotive springs, with high availability, short delivery times, and competitive prices.



## TAPERED COIL SPRING

### Vauxhall Astra Mk5 04>

Sachs, Rear  
**£51.95**  
627 72 2728



### Mercedes Vito STD 03>

Sachs, Rear  
**£66.95**  
627 22 1848



## COIL SPRING

### Vauxhall Astra Mk5 04>

Sachs, Rear  
**£31.95**  
627 72 2720

Anschler, Rear  
**£22.95**  
627 72 2721



### Mercedes Vito STD 03>

Sachs, Rear  
**£32.95**  
627 22 1840

Anschler, Rear  
**£24.95**  
627 22 1841



### Ford Focus 04>

Sachs, Front  
**£28.95**  
627 59 1460

Anschler, Front  
**£20.95**  
627 59 1461



### Vauxhal Vectra MkII 00-08

Sachs, Front  
**£17.95**  
627 72 0680

Anschler, Front  
**£14.95**  
627 72 0681



### Ford Mondeo 00>

Sachs, Front  
**£19.95**  
627 59 0340

Anschler, Front  
**£15.95**  
627 59 0341



### Citroen C3 02>

Sachs, Front  
**£24.95**  
627 54 5430

Anschler, Front  
**£19.95**  
627 54 5431



**ANY PART FOR ANY CAR  
OVER 200 BRANCHES NATIONWIDE**



# SAFELY ON THE ROAD WITH SACHS

**SACHS** shock absorbers distinguish themselves through original equipment quality and innovative technology. They provide performance and dynamics, ensuring perfect road grip and cornering behaviour, no matter what challenges the road presents.

One in seven cars has defective shock absorbers. The problem: Shock absorbers wear down gradually. In most cases, the driver does not notice the increasingly sluggish steering behaviour of the vehicle. The defective shock

absorbers become apparent only in an extreme emergency situation, for example in a sudden evasive manoeuvre or during emergency braking. Therefore, shock absorbers must be inspected by an expert after every **50,000 miles**.

Numerous well-known automotive manufacturers equip their new vehicles as standard with **SACHS** shock absorbers. The original equipment know-how is also used for spare parts production. Therefore, **SACHS** shock absorbers for the aftermarket are always state-of-the-art.

## SHOCK ABSORBERS

### Audi A6 97 - 05

Sachs, Rear  
**£37.95**  
635 44 0010

Anschler, Rear  
**£30.95**  
635 44 0011



### VW Golf MkVI 08-13

Sachs, Front  
**£34.95**  
635 44 0220

Anschler, Front  
**£29.95**  
635 44 0221



### BMW 3 (E90) 05>

Sachs, Rear  
**£44.95**  
635 11 0580

Anschler, Rear  
**£37.95**  
635 11 0581



### VW Passat 05-14

Sachs, Front  
**£47.95**  
635 44 1470

Anschler, Front  
**£40.95**  
635 44 1471



### Fiat Punto 99>

Sachs, Rear  
**£20.95**  
635 58 0010

Anschler, Rear  
**£17.95**  
635 58 0011



### VW Passat 05-14

Sachs, Rear  
**£46.95**  
635 44 0140

Anschler, Rear  
**£39.95**  
635 44 0141



## ARNOTT AIR SUSPENSION



### AIR SUSPENSION COMPRESSORS

#### Range Rover Sport

**£367.95**  
626 67 0260

#### Mercedes 211, 219, 220, 240

**£225.95**  
626 22 0280

#### BMW X5 (E70), X6 (E71) 07-13

**£311.95**  
626 11 0720

### AIR SPRINGS

#### Audi A6 (C5) Allroad 01-06

**£226.95**  
626 44 0931

#### BMW X5 (E70) 07-11

**£146.95**  
626 11 0711

#### Mercedes (E-Class W211) 03-09

**£276.95**  
626 22 3301

## DRIVE SHAFTS



### Citreon Dispatch 07>

LH, GKN

**£123.30**

654 54 9140

LH, Q-Drive

**£77.80**

654 54 9141

### Citreon Dispatch 07>

RH, GKN

**£123.30**

654 54 9150

RH, Q-Drive

**£78.80**

654 54 9151

### Vauxhall Movano 10>

LH, GKN

**£145.50**

654 72 8130

LH, Q-Drive

**£94.99**

654 72 8131

### Vauxhall Movano 10>

RH, GKN

**£141.40**

654 72 8140

RH, Q-Drive

**£69.70**

654 72 8141

### VW Golf 04-09

RH, GKN

**£116.20**

654 44 9920

RH, Q-Drive

**£73.80**

654 44 9921

### VW Golf 04-09

LH, GKN

**£108.10**

654 44 9930

LH, Q-Drive

**£73.80**

654 44 9931



## WHEEL BEARING

### Ford Focus / Fusion

Rear, SKF

**£22.00**

628 59 0060

Rear, Q-Drive

**£19.50**

628 59 0061

### Ford Transit

Front, SKF

**£44.20**

628 59 5170

Front, Q-Drive

**£38.10**

628 59 5171

### Ford Transit

Front, FAG

**£37.20**

628 59 0020

Front, Q-Drive

**£31.30**

628 59 0021

### Renault Clio / Megane / Note

Rear, SNR

**£18.00**

628 74 5120

Rear, Q-Drive

**£15.50**

628 74 5121

### Skoda Octavia / Audi TT

Front, FAG

**£69.28**

628 44 1150

Front, Q-Drive

**£55.69**

628 44 1151

### VW Golf / Audi A2 / Seat Leon

Rear, SNR

**£67.70**

628 44 1360

Rear, Q-Drive

**£43.27**

628 44 1361

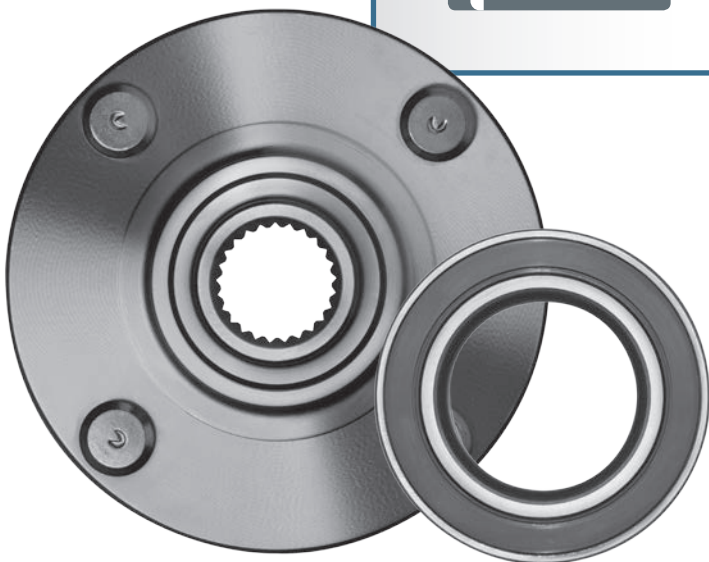

**ANY PART FOR ANY CAR  
OVER 200 BRANCHES NATIONWIDE**



## CV JOINTS



### Audi A3 / VW Golf

Outer, GKN

**£54.60**

657 44 5020

Outer, Q-Drive

**£23.80**

657 44 5021

### Audi A4, A6 / VW Passat / Skoda Superb

Outer, GKN

**£69.70**

657 44 3140

Outer, Q-Drive

**£25.20**

657 44 3141

### Audi A4, A6 / VW Passat / Skoda Superb

Outer, GKN

**£71.80**

657 44 4130

Outer, Q-Drive

**£40.99**

657 44 4131

### Audi A2 . Seat Ibiza / VW Polo / Skoda Fabia

Outer, GKN

**£52.60**

657 44 2180

Outer, Q-Drive

**£24.80**

657 44 2181

### Audi A3 / VW Golf

Outer, GKN

**£52.60**

657 79 1010

Outer, Q-Drive

**£23.80**

657 79 1011

### Audi A4, A6 / VW Passat / Skoda Superb

Outer, GKN

**£59.60**

657 44 3900

Outer, Q-Drive

**£23.80**

657 44 3901



## CV BOOTS

### Audi A1, A2 / Seat Ibiza, Toledo / Skoda Fabia, Rapid, Roomster / VW Golf MkIII, Polo

Outer, GKN

**£8.40**

656 79 0020

Inner, Q-Drive

**£8.30**

656 79 0021

### BMW 3 Series / Ford Fiesta / Mazda 626 / Rover / MG

Outer, GKN

**£4.95**

656 59 0650

Inner, Q-Drive

**£4.05**

656 59 0651

### Citroen Range (Incl Ds Range) / Peugeot Range

Outer, GKN

**£13.10**

656 54 6150

Inner, Q-Drive

**£8.40**

656 54 6151

### Mercedes Vito, V-Class

Inner, GKN

**£12.10**

656 22 3120

Inner, Q-Drive

**£9.99**

656 22 3121

### Vauxhall Corsa

Outer, GKN

**£8.40**

656 72 0520

Inner, Q-Drive

**£8.30**

656 72 0521

### Vauxhall Corsa, Meriva, Tigra

Inner, GKN

**£6.50**

656 72 0530

Inner, Q-Drive

**£6.05**

656 72 0531



# CLUTCH CLINIC

## CSC – CONCENTRIC SLAVE CYLINDERS

**In 2017, over 130 million vehicles are expected to be equipped with a CSC.**

With changing technologies and new car manufacturers' requirements, it has become difficult to fit clutch cables in a straight line between the pedal and the lever. That's why more and more cars are now using the CSC hydraulic systems. These are much more flexible and reliable compared to manual systems, and they also enable an optimal and constant pedal effort.

The CSC is a hydraulic cylinder with an integrated release bearing which eliminates the clutch lever and the conventional release bearing. It is connected to the master cylinder via the hose. The CSC is in direct contact with the clutch cover assembly diaphragm, increasing the efficiency of the hydraulic system.

The material used today to manufacture the CSC is now much lighter (up to 70% reduction of weight compared to the standard clutch system release mechanism) as well as much more compact. This is the main reason why this technology is far easier to implement on OE projects. In response to this market trend, a wide range of hydraulic parts have been developed: the clutch master cylinder, clutch slave cylinder and the CSC. Both the clutch master cylinder and the slave cylinder are used in "semi-hydraulic" system, whereas a "full hydraulic" system uses the master cylinder and the CSC.

The main advantage of the CSC is that it eliminates the fork and the release bearing. There are no more deformations of the fork under load and the release system efficiency is increased. Therefore the pedal load is reduced. The CSC is concentric to the gear box input shaft.

The weight of the CSC sub assembly has been around 1,000 grams, compared to full function with bearing, fork and guiding tube, weighs about 1,700 grams. However from the early 90's the widespread use of plastic materials has resulted in both weight and costs of the parts being considerably reduced. Today, the total weight of the sub assembly is now around 400 grams.

When a clutch is replaced it is essential that the CSC is also replaced at the same time. After many clutch actuations the rubber seals become worn and the operating position within the chamber of

the CSC changes, which means the worn internal components are no longer aligned. It is imperative that the rubber seals inside CSCs are of the highest quality to ensure there is no loss of hydraulic fluid. If fluid is allowed to pass through the seals

it will contaminate the friction material on the disc, which will result in clutch failure.

A semi-automatic gearbox with an electronic clutch will utilise sensor technology, actuation is made by an electronic unit associated to a hydraulic power unit, eliminating the clutch pedal, the master cylinder and the hose. A sensor is attached to the CSC to detect the stroke sending this information to the electronic control unit, to either engage or disengage.



**ANY PART FOR ANY CAR  
OVER 200 BRANCHES NATIONWIDE**





## 3PCS CLUTCH KIT

**BMW 320CD M47N204D4**

LUK  
**£134.86**

641 11 0850

**Ford/Mazda Fusion/Fiesta 1.25 1.3 1.4**

Valeo VPH  
**£39.95**

641 59 2380

**Toyota Avensis 2.0/Celica 1.8/MR2**

Exedy  
**£54.06**

641 82 0010

**Citroen / Peugeot for OE solid flywheel**

AP  
**£81.83**

641 54 6410

**VAG 1.9 LUK SAC type with bolts**

LUK  
**£124.53**

641 44 2070

**Toyota Aygo/Citroen C1 998C**

Valeo PHC  
**£63.66**

641 73 5545

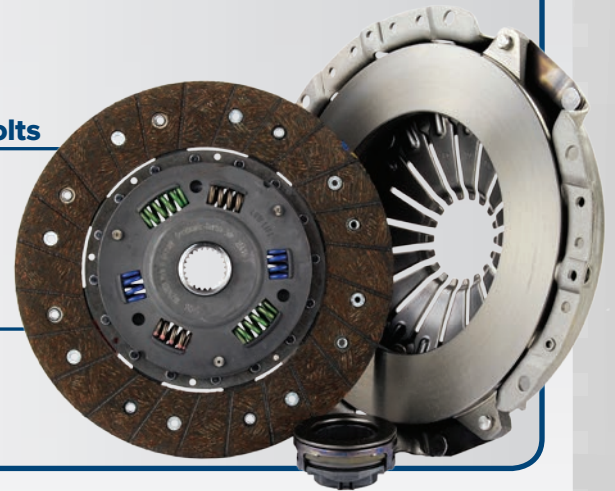

## 3PCS CLUTCH KIT + CONCENTRIC SLAVE CYLINDER

**Audi A3 1.8 Turbo 98 - 03**

LUK  
**£141.93**

637 44 1710

**Nissan Micra + CC/Note/  
Qashqai/Tida 1.6**

LUK  
**£98.48**

637 70 2110

**Mercedes SAC type with CSC**

LUK  
**£222.23**

637 22 1400

**Ford Fiesta MkV 1.4 16V**

VALEO  
**£82.17**

637 59 2380

**Nissan/Renault Primastar/Traffic/  
Vivaro 2.5Dci/Dti 2 bolts CSC**

LUK  
**£157.78**

637 74 9340

**Vauxhall 1.9Cdti M32 G/Box**

LUK  
**£165.78**

637 72 3580



## NEVER COMPRESS THE CSC BY HAND

Why do so many technicians want to do this when taking the CSC out of its box? Never, ever compress a CSC by hand to replicate the bearing movement. The CSC doesn't need to be primed before installation. Compressing the cylinder in this way will increase air pressure that can cause the damage that will render the unit unserviceable. As the chamber is not pre-filled with hydraulic fluid, then damage will be caused to the internal seals due to excessive friction on the return stroke.





# Nilfisk

trusted since 1906

The Nilfisk family of mobile high-pressure washers can cope with the toughest of cleaning situations. You can trust them to do the job in a wide range of settings including agriculture, automotive, building & construction, rental, food industry and manufacturing & warehousing.

## NILFISK SWEEPER SCRUBBER DRIER BATTERY POWERED

The Nilfisk Scrubtec 334 C is a compact scrubber dryer for fast and effective cleaning of hard floors, which will take you into every corner and ensure efficient cleaning in both directions – also under furniture and shelves.

- Easy handling – Tank-in-tank design for carrying in one hand gives an easy emptying and refilling
- Effective – Sweeping, scrubbing and drying at the same time

**£1,199.99**

965 77 1350



## NILFISK HOT WATER AND STEAM PRESSURE WASHER 90 BAR

The MH 2C model is ideal for everyday, low frequency cleaning tasks in the automotive segment, for tradesmen or around small farms. The MH 2C combines a unique, highly mobile design with great performance levels and ground breaking features from the larger MH lines.

- EcoPower boiler with >92% efficiency and reduced fuel cost
- Robust steel frame
- Compact, vertical design reducing storage footprint
- Easy to use control panel... all controls in one place
- Ergo accessory system for additional user comfort
- Machine protection through low fuel sensor, exhaust gas sensor, flame sensor.
- Duo Motor system

**£1,499.99**

965 77 1330



**ANY PART FOR ANY CAR  
OVER 200 BRANCHES NATIONWIDE**





## NILFISK HOT WATER AND STEAM PRESSURE WASHER 100 BAR

The MH 4M series takes mid-range hot water high pressure washers to a new level, meeting the latest productivity demands in the market.

- High efficiency 4 pole motors
- EcoPower boiler with EcoMode function
- Brass pump head 3 ceramic pistons
- Pressure activated unloader system
- Innovative design with 4 big wheels

**£1,799.99**

965 77 1340

## NILFISK ENTRY LEVEL HOT WATER PRESSURE WASHER 110 BAR

MH 1C is a compact and innovative hot water unit ideal for low intensity and infrequent cleaning applications around small garages or farms, car dealers or by tradesmen and craftsmen.

- EcoPower boiler with >92% efficiency and reduced fuel costs
- Robust steel frame
- Compact, vertical design reducing storage footprint
- Easy to use control panel... all controls in one place
- Ergo accessory system

**£1,149.99**

965 77 1320



## NILFISK WET AND DRY VAC WITH POWER TAKE OFF FOR POWER TOOLS

The AERO 26 is the feature model of the AERO 21/26 series with high focus on application and end-user needs. Push&Clean filter cleaning system and exhaust air blow function is found on all models together with flexible and convenient accessory storage.

- Washable PET fleece filter with minimum 99,9% filtration efficiency
- MultiFit accessory system for ultimate flexibility

**£110.00**

965 77 1360



# Introducing... The Warranty of a Lifetime

## The Warranty of a Lifetime

Being independent can have its challenges, but can also open the way to great opportunities not available to a main dealer.

One of the best is the unique Euro Car Parts warranty of a lifetime.

We're the only UK parts supplier offering you and your customers guaranteed reassurance for the lifetime of each mechanical part you supply and fit.

**ANY PART FOR ANY CAR**  
OVER 200 BRANCHES NATIONWIDE

**UK**  
**CAR PARTS**